

Mounting and Flashing Systems

Exposed Fastener Type Flat Panel

Date: _____

Project: _____

Contact: _____

Company: _____

Phone: _____

Email: _____

Brake Formed Pieces

Date: _____

Project: _____

EFB01

Perforated top of panel closure at termination beneath coping, window sill, or other flashing.

Material: 0.032" Alum.
Pre-finish: 'Black'
Sections: 10'-0"

Total ft: _____

Pieces: _____

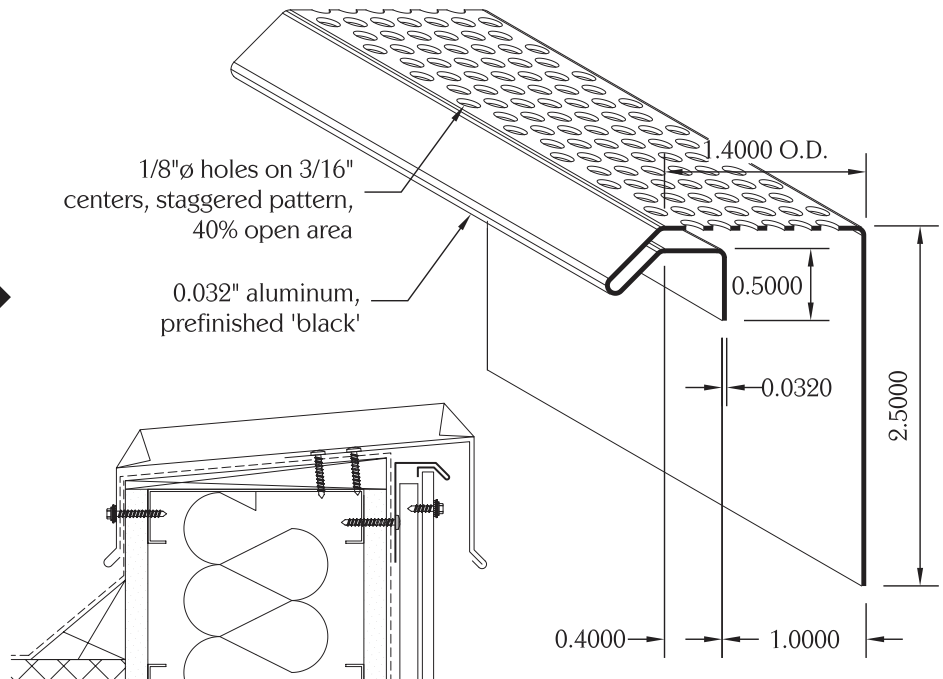

EFB02

Perforated termination closure flashing at panel sill conditions.

Material: 0.032" Alum.
Pre-finish: 'Black'
Sections: 10'-0"

Total ft: _____

Pieces: _____

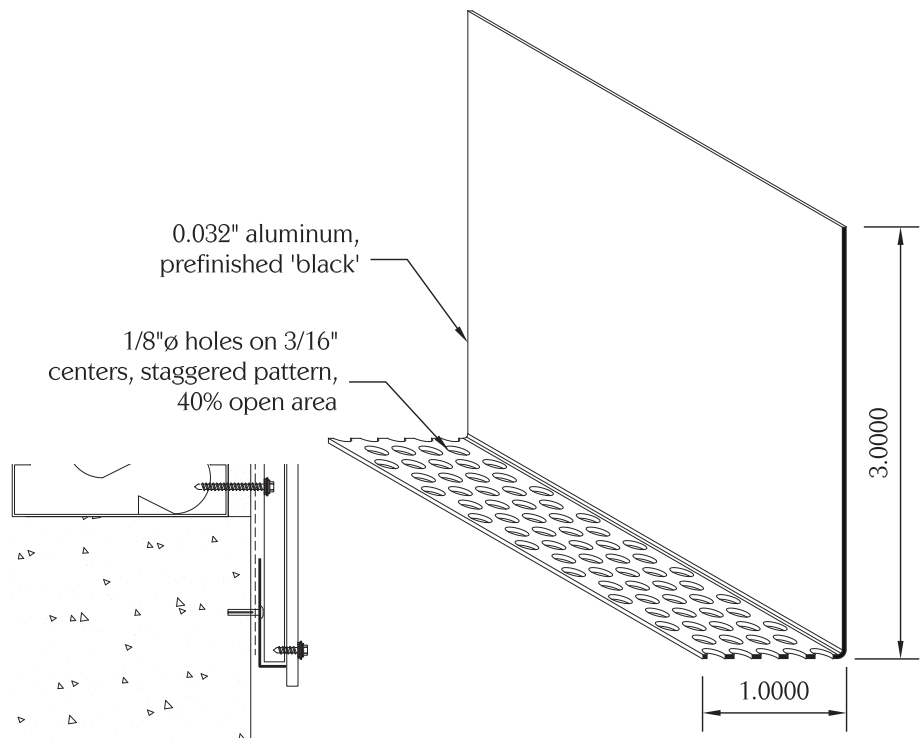

Details provided are for reference only, and should not be used unless advised by a waterproofing consultant. NorthClad is not responsible for performance of any of the details or shapes shown. It is the purchaser's responsibility to provide their own project specific design and engineering, and to adhere to the WRB manufacturer's instructions.

Brake Formed Pieces

Date: _____

Project: _____

EFB03

Brake formed horizontal
Joint Flashing.

Material: 0.032" Alum.
Pre-finish: 'Black'
Sections: 10'-0"

Total ft: _____

Pieces: _____

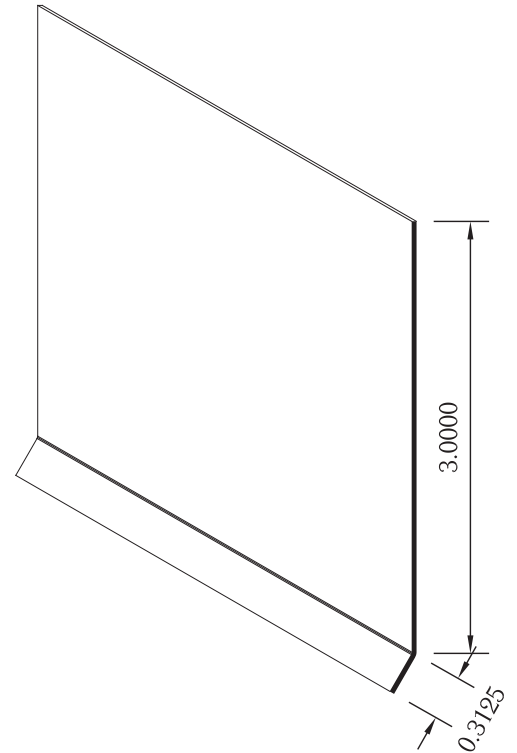
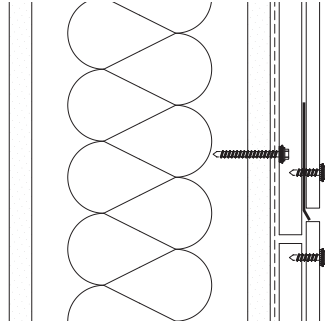

EFB04

Brake formed inside
corner closure flashing.

Material: 0.032" Alum.
Pre-finish: 'Black'
Sections: 10'-0"

Total ft: _____

Pieces: _____

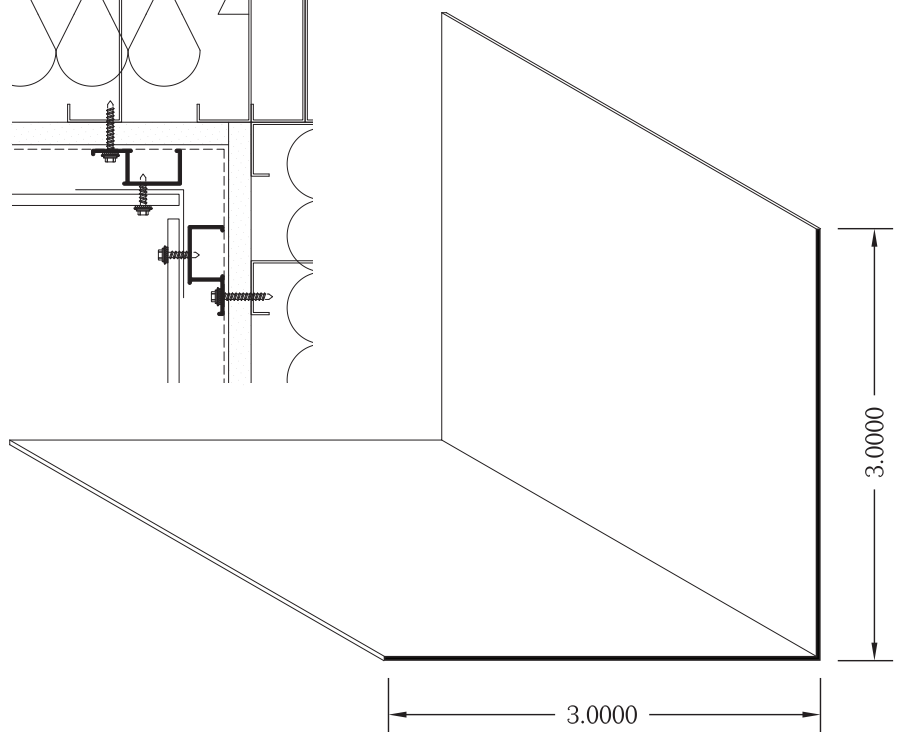
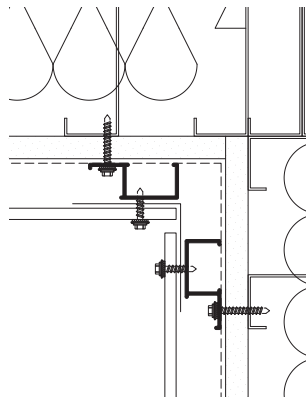

Details provided are for reference only, and should not be used unless advised by a waterproofing consultant. NorthClad is not responsible for performance of any of the details or shapes shown. It is the purchaser's responsibility to provide their own project specific design and engineering, and to adhere to the WRB manufacturer's instructions.

Extrusion Pieces

Date: _____

Project: _____

EFEB

Extruded aluminum
closure support for
use at outside corner
conditions.

Material: 0.090" Alum.
Pre-finish: 'Black'
Sections: 20'-0"

Total ft: _____

Pieces: _____

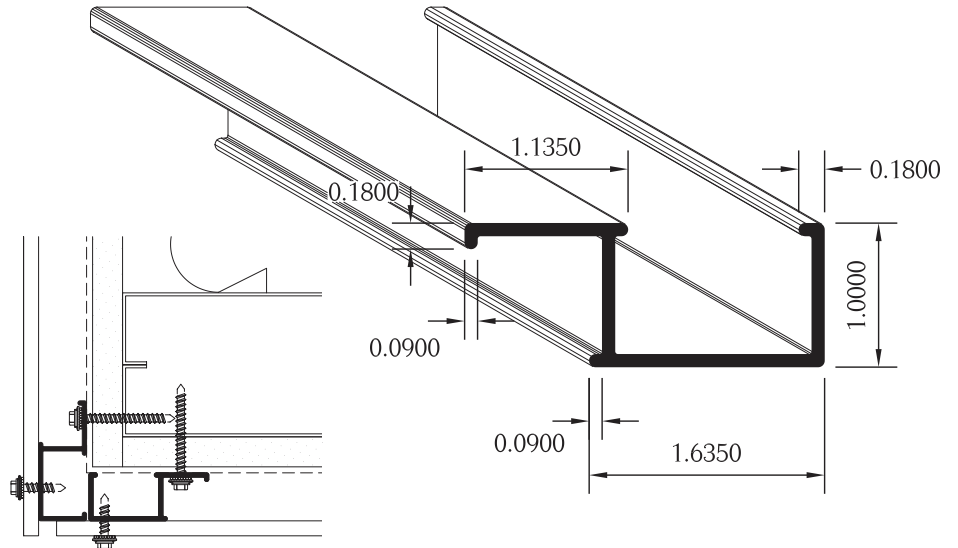

EFEB

Extruded aluminum
closure support for
use at inside corner
conditions.

Material: 0.090" Alum.
Pre-finish: 'Black'
Sections: 20'-0"

Total ft: _____

Pieces: _____

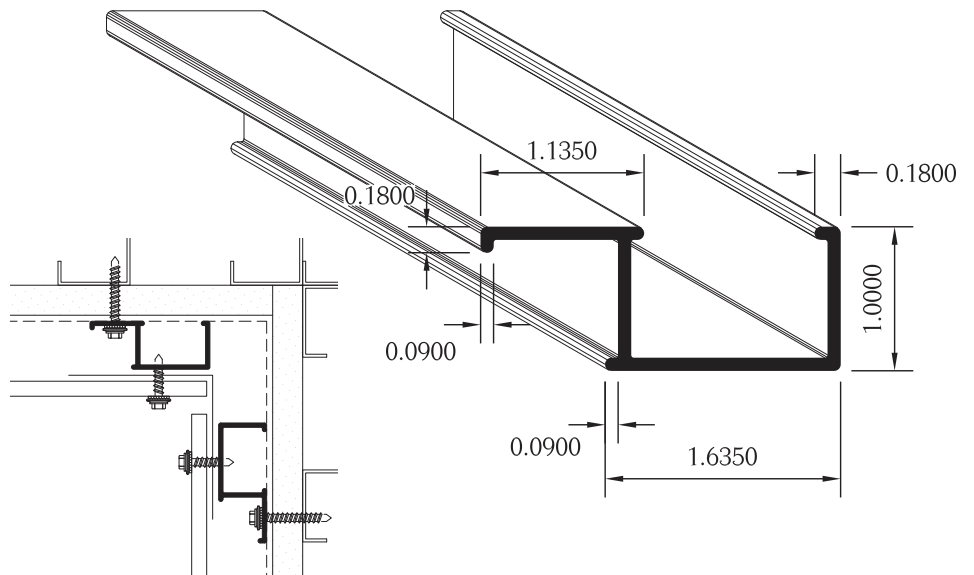

Details provided are for reference only, and should not be used unless advised by a waterproofing consultant. NorthClad is not responsible for performance of any of the details or shapes shown. It is the purchaser's responsibility to provide their own project specific design and engineering, and to adhere to the WRB manufacturer's instructions.

Extrusion Pieces

Date: _____

Project: _____

EFEB

Extruded aluminum closure support for use at closure and jamb conditions.

Material: 0.090" Alum.
Pre-finish: 'Black'
Sections: 20'-0"

Total ft: _____

Pieces: _____

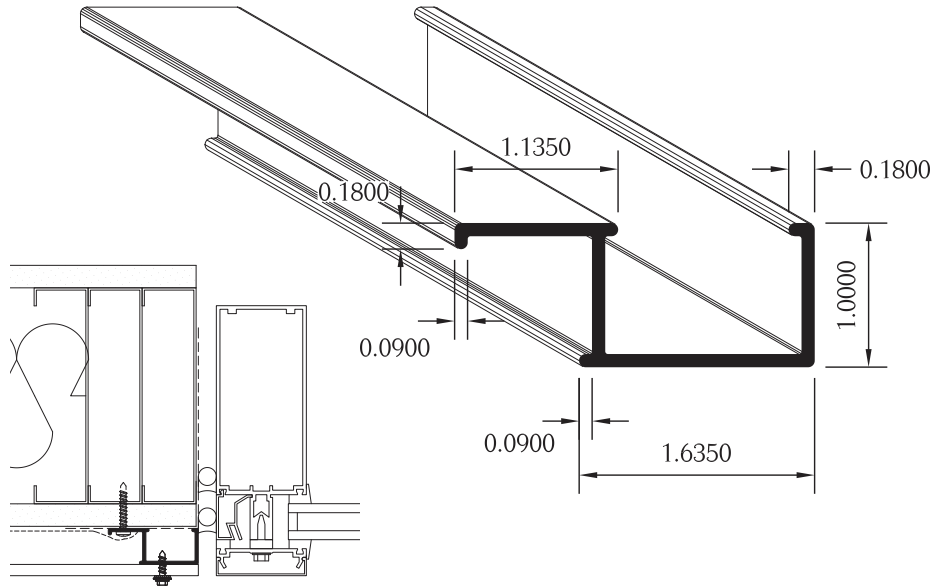

EFHB

Extruded aluminum channel at vertical joint locations.

Material: 0.090" Alum.
Pre-finish: 'Black'
Sections: 20'-0"

Total ft: _____

Pieces: _____

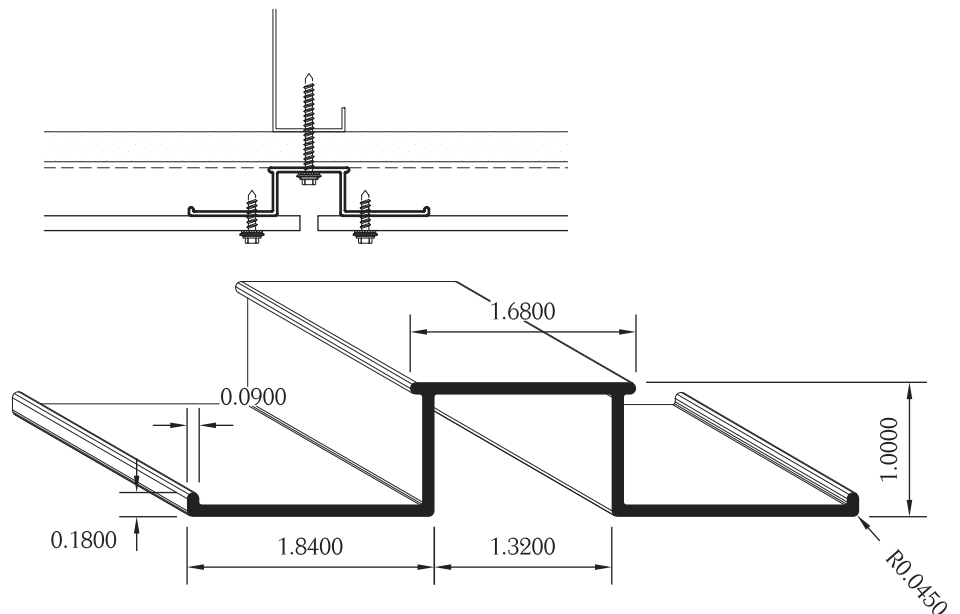

Details provided are for reference only, and should not be used unless advised by a waterproofing consultant. NorthClad is not responsible for performance of any of the details or shapes shown. It is the purchaser's responsibility to provide their own project specific design and engineering, and to adhere to the WRB manufacturer's instructions.

Extrusion Pieces

Date: _____

Project: _____

EFZM

Extruded aluminum zee shape at field fastener conditions. Not exposed in system.

Material: 0.090" Alum.
Pre-finish: None
Sections: 20'-0"

Total ft: _____

Pieces: _____

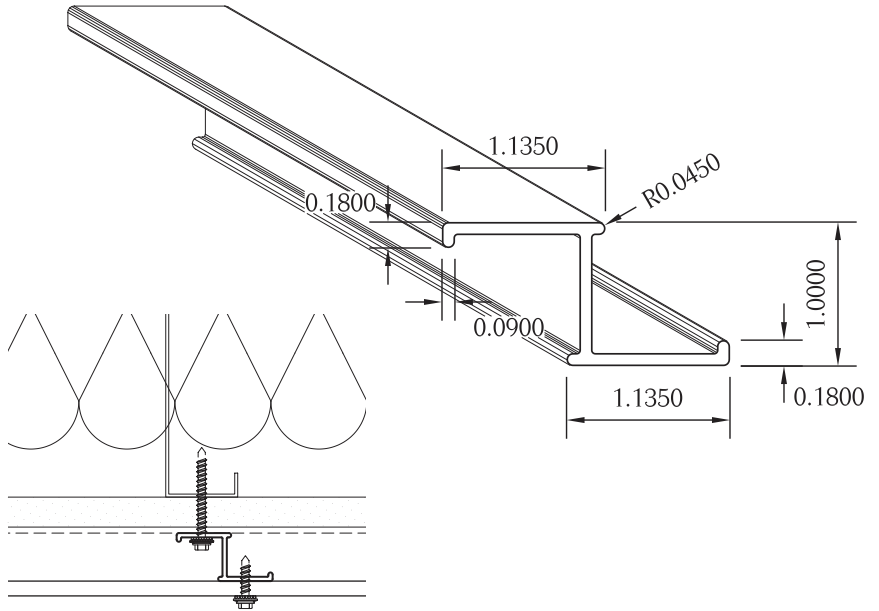

EFZB

Extruded aluminum zee shape at field fastener conditions. Not exposed in system.

Material: 0.090" Alum.
Pre-finish: 'Black'
Sections: 20'-0"

Total ft: _____

Pieces: _____

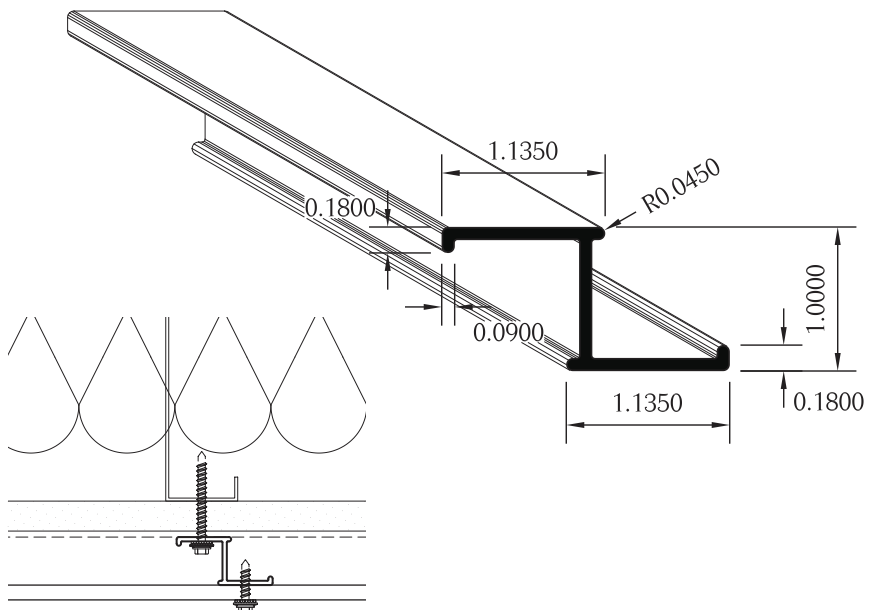

Details provided are for reference only, and should not be used unless advised by a waterproofing consultant. NorthClad is not responsible for performance of any of the details or shapes shown. It is the purchaser's responsibility to provide their own project specific design and engineering, and to adhere to the WRB manufacturer's instructions.

Fastener Options

Date: _____

Project: _____

Standard Fasteners

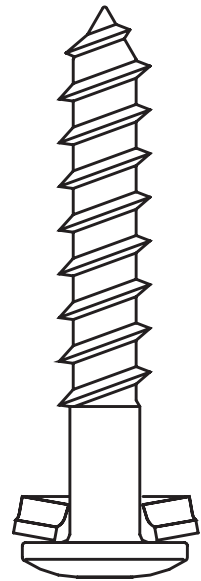
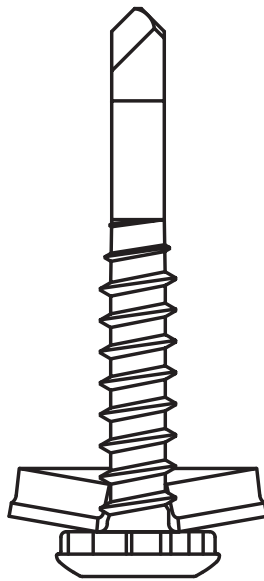
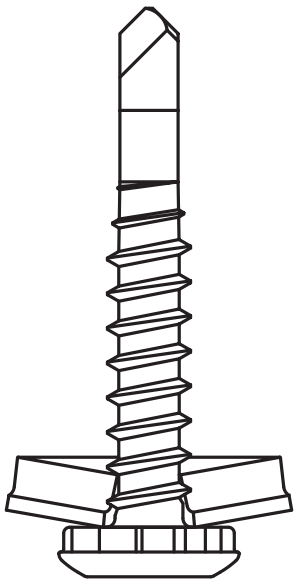

EFF1

#14 x 1-1/8" Irius®
304 Stainless Steel

Pieces

EFF2

#14 x 1-1/4" Irius®
304 Stainless Steel

Pieces

EFF3

#14 x 1-3/16" TW-S
304 Austenitic
Stainless Steel

Pieces

Details provided are for reference only, and should not be used unless advised by a waterproofing consultant. NorthClad is not responsible for performance of any of the details or shapes shown. It is the purchaser's responsibility to provide their own project specific design and engineering, and to adhere to the WRB manufacturer's instructions.

Order Summary

Date: _____

Project: _____

EFB01

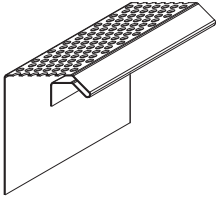

Total ft: _____
Pieces: _____

EFB02

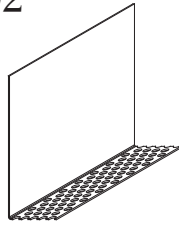

Total ft: _____
Pieces: _____

EFB03

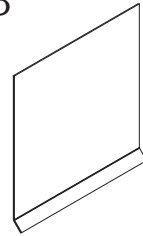

Total ft: _____
Pieces: _____

EFB04

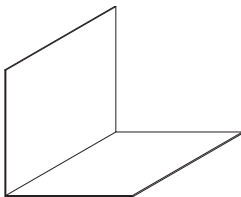

Total ft: _____
Pieces: _____

EFEB

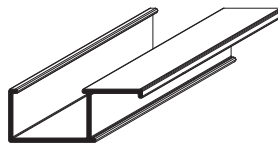

Total ft: _____
Pieces: _____

EFHB

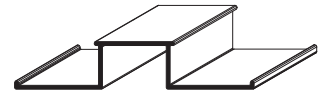

Total ft: _____
Pieces: _____

EFZM

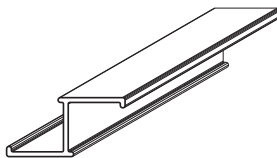

Total ft: _____
Pieces: _____

EFZB

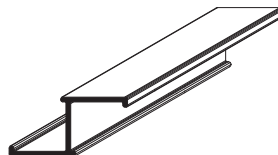

Total ft: _____
Pieces: _____

EFF1

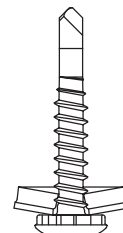

Pieces: _____

EFF2



Pieces: _____

EFF3

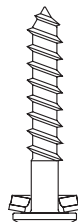

Pieces: _____

Details provided are for reference only, and should not be used unless advised by a waterproofing consultant. NorthClad is not responsible for performance of any of the details or shapes shown. It is the purchaser's responsibility to provide their own project specific design and engineering, and to adhere to the WRB manufacturer's instructions.