

Key Elevation
System: AL Stacking with Inboard Insulation



11831 BEVERLY PARK RD. BUILDING C, EVERETT, WA 98204
* PHONE: 425.740.3702 * FAX: 425.485.3503 *
www.northclad.com

This document is property of NorthClad and should not be used, duplicated or modified without the express written consent. Copyright © 2010 NorthClad All Rights Reserved

NO.	DESCRIPTION	DATE	INIT.
1	Design	05/14/2018	M E
2	-	-	-
3	-	-	-
4	-	-	-
5	-	-	-
6	-	-	-
7	-	-	-
8	-	-	-
9	-	-	-
10	-	-	-

Project

NorthClad AL Stacking System

11831 Beverly Park Rd, Bldg C
Everett, WA 98204

Category	ELEV
Scale	NTS
Job Number	NC0000
Sheet	KEY
APPROVED	

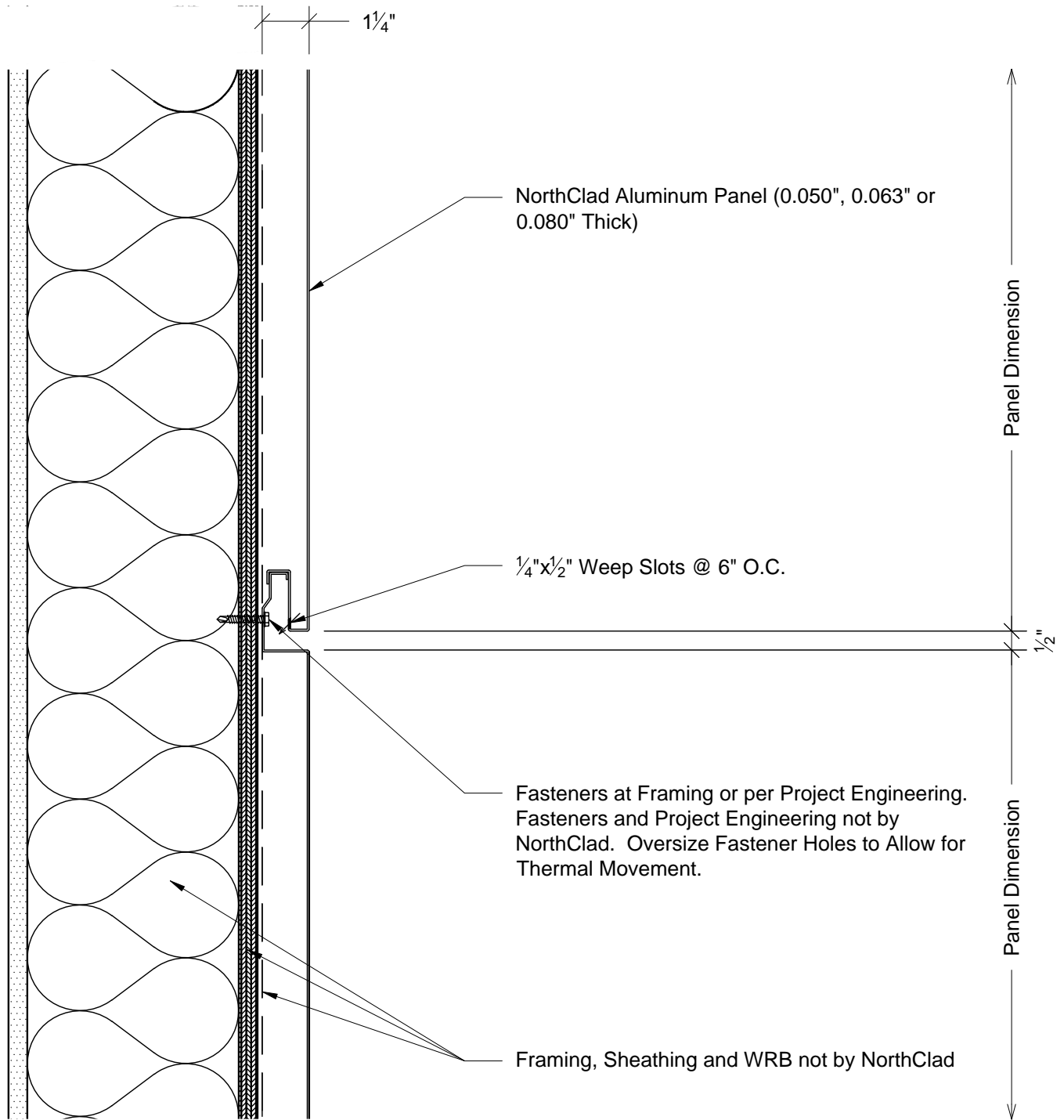

A Section - Edge of Panels at Horizontal Joint
 System: AL Stacking with Inboard Insulation



11831 BEVERLY PARK RD. BUILDING C, EVERETT, WA 98204
 * PHONE: 425.740.3702 * FAX: 425.485.3503 *
 www.northclad.com

This document is property of NorthClad and should not be used, duplicated or modified without the express written consent. Copyright © 2010 NorthClad All Rights Reserved

NO.	DESCRIPTION	DATE	INIT.
1	Design	05/14/2018	ME
2	-	-	-
3	-	-	-
4	-	-	-
5	-	-	-
6	-	-	-
7	-	-	-
8	-	-	-
9	-	-	-
10	-	-	-

Project
NorthClad AL Stacking System

11831 Beverly Park Rd, Bldg C
 Everett, WA 98204

Category	DET
Scale	3" = 1'-0"
Job Number	NC0000
Sheet	A
APPROVED	

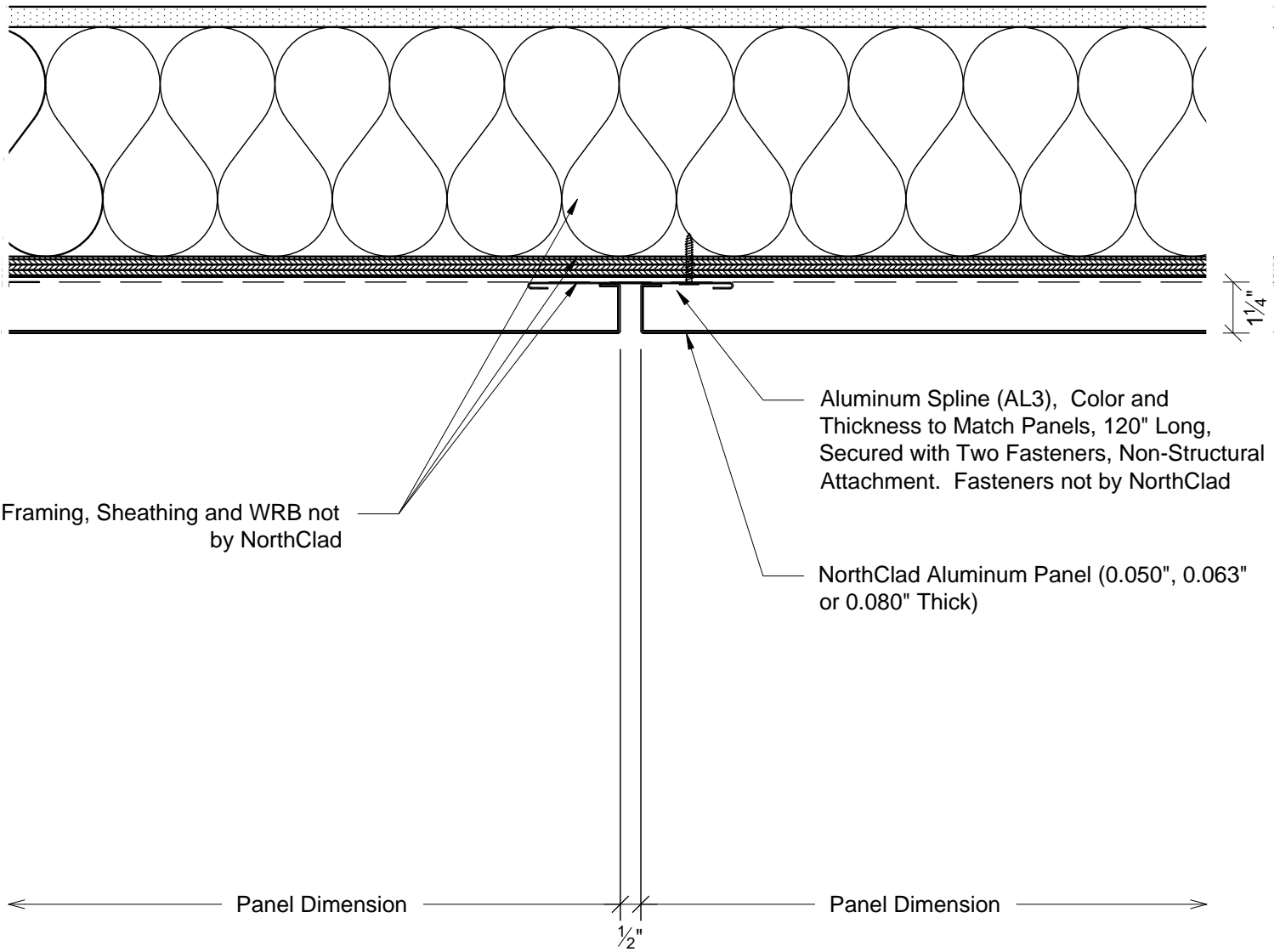

B Plan - Edge of Panels at Vertical Joint
System: AL Stacking with Inboard Insulation



11831 BEVERLY PARK RD. BUILDING C, EVERETT, WA 98204
* PHONE: 425.740.3702 * FAX: 425.485.3503 *
www.northclad.com

This document is property of NorthClad and should not be used, duplicated or modified without the express written consent. Copyright © 2010 NorthClad All Rights Reserved

NO.	DESCRIPTION	DATE	INIT.
1	Design	05/14/2018	M E
2	-	-	-
3	-	-	-
4	-	-	-
5	-	-	-
6	-	-	-
7	-	-	-
8	-	-	-
9	-	-	-
10	-	-	-

Project
NorthClad AL Stacking System

11831 Beverly Park Rd, Bldg C
Everett, WA 98204

Category	DET
Scale	3" = 1'-0"
Job Number	NC0000
Sheet	B
APPROVED	

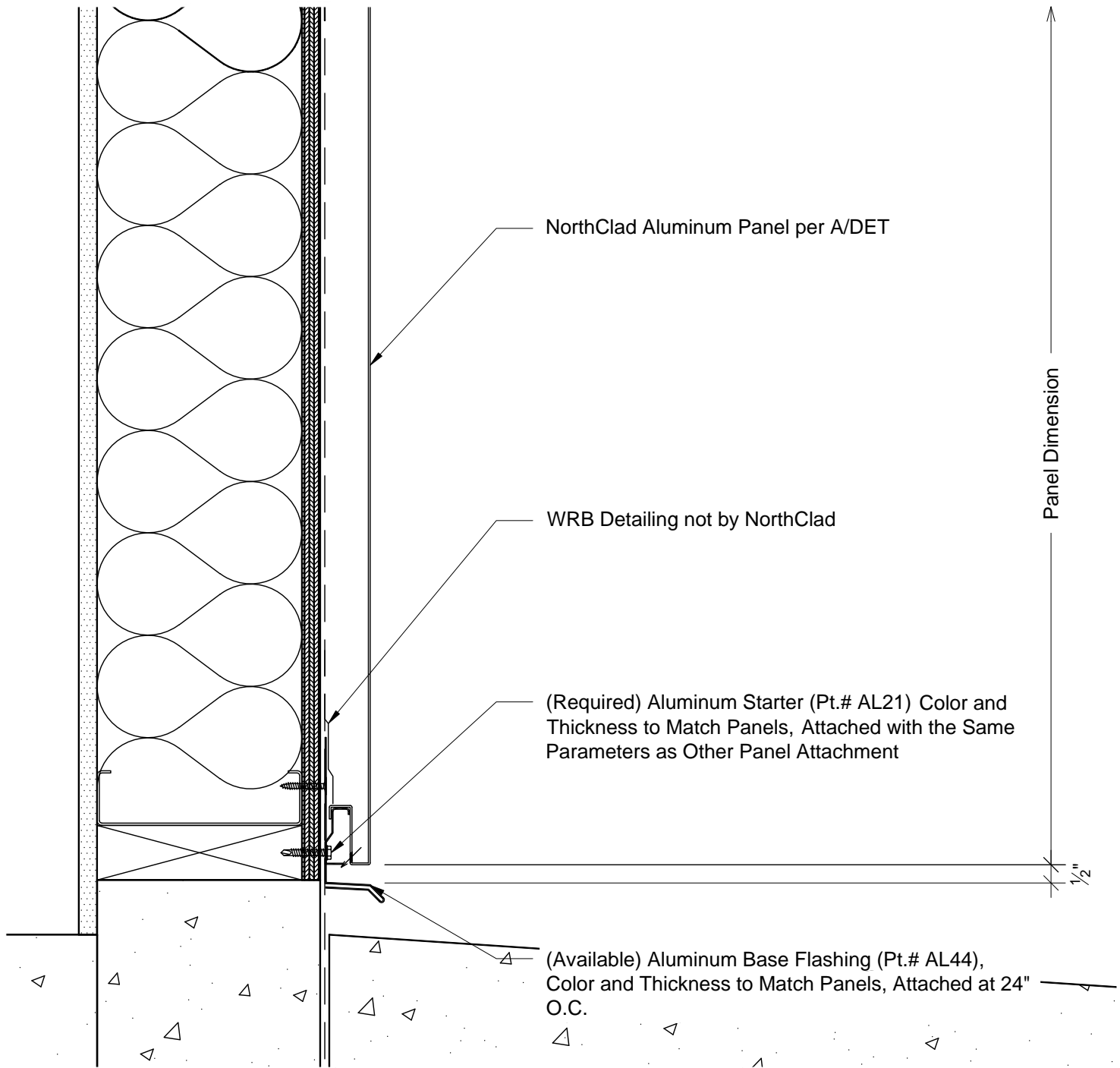

NorthClad Aluminum Panel per A/DET

WRB Detailing not by NorthClad

(Required) Aluminum Starter (Pt.# AL21) Color and Thickness to Match Panels, Attached with the Same Parameters as Other Panel Attachment

(Available) Aluminum Base Flashing (Pt.# AL44), Color and Thickness to Match Panels, Attached at 24" O.C.

Panel Dimension

1/2"

C

Section - Bottom of Panel at Base of Wall
System: AL Stacking with Inboard Insulation



11831 BEVERLY PARK RD. BUILDING C, EVERETT, WA 98204
* PHONE: 425.740.3702 * FAX: 425.485.3503 *
www.northclad.com

This document is property of NorthClad and should not be used, duplicated or modified without the express written consent. Copyright © 2010 NorthClad All Rights Reserved

NO.	DESCRIPTION	DATE	INIT.
1	Design	05/14/2018	ME
2	-	-	-
3	-	-	-
4	-	-	-
5	-	-	-
6	-	-	-
7	-	-	-
8	-	-	-
9	-	-	-
10	-	-	-

Project

NorthClad AL Stacking System

11831 Beverly Park Rd, Bldg C
Everett, WA 98204

Category	DET
Scale	3" = 1'-0"
Job Number	NC0000
Sheet	C
APPROVED	

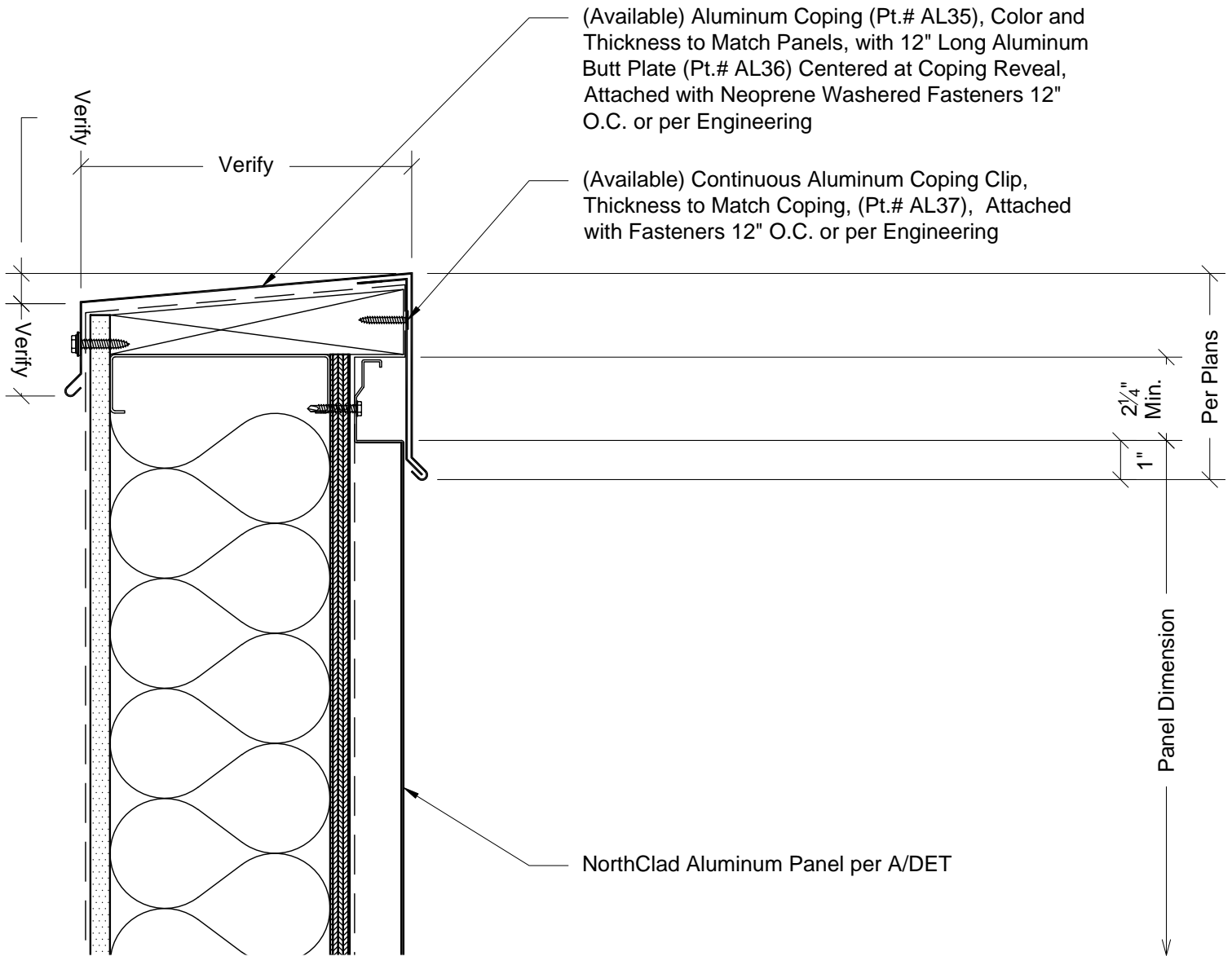

D Section - Top of Panel at Coping
System: AL Stacking with Inboard Insulation



11831 BEVERLY PARK RD. BUILDING C, EVERETT, WA 98204
* PHONE: 425.740.3702 * FAX: 425.485.3503 *
www.northclad.com

This document is property of NorthClad and should not be used, duplicated or modified without the express written consent. Copyright © 2010 NorthClad All Rights Reserved

NO.	DESCRIPTION	DATE	INIT.
1	Design	05/14/2018	M E
2	-	-	-
3	-	-	-
4	-	-	-
5	-	-	-
6	-	-	-
7	-	-	-
8	-	-	-
9	-	-	-
10	-	-	-

Project

NorthClad AL Stacking System

11831 Beverly Park Rd, Bldg C
Everett, WA 98204

Category	DET
Scale	3" = 1'-0"
Job Number	NC0000
Sheet	D
APPROVED	

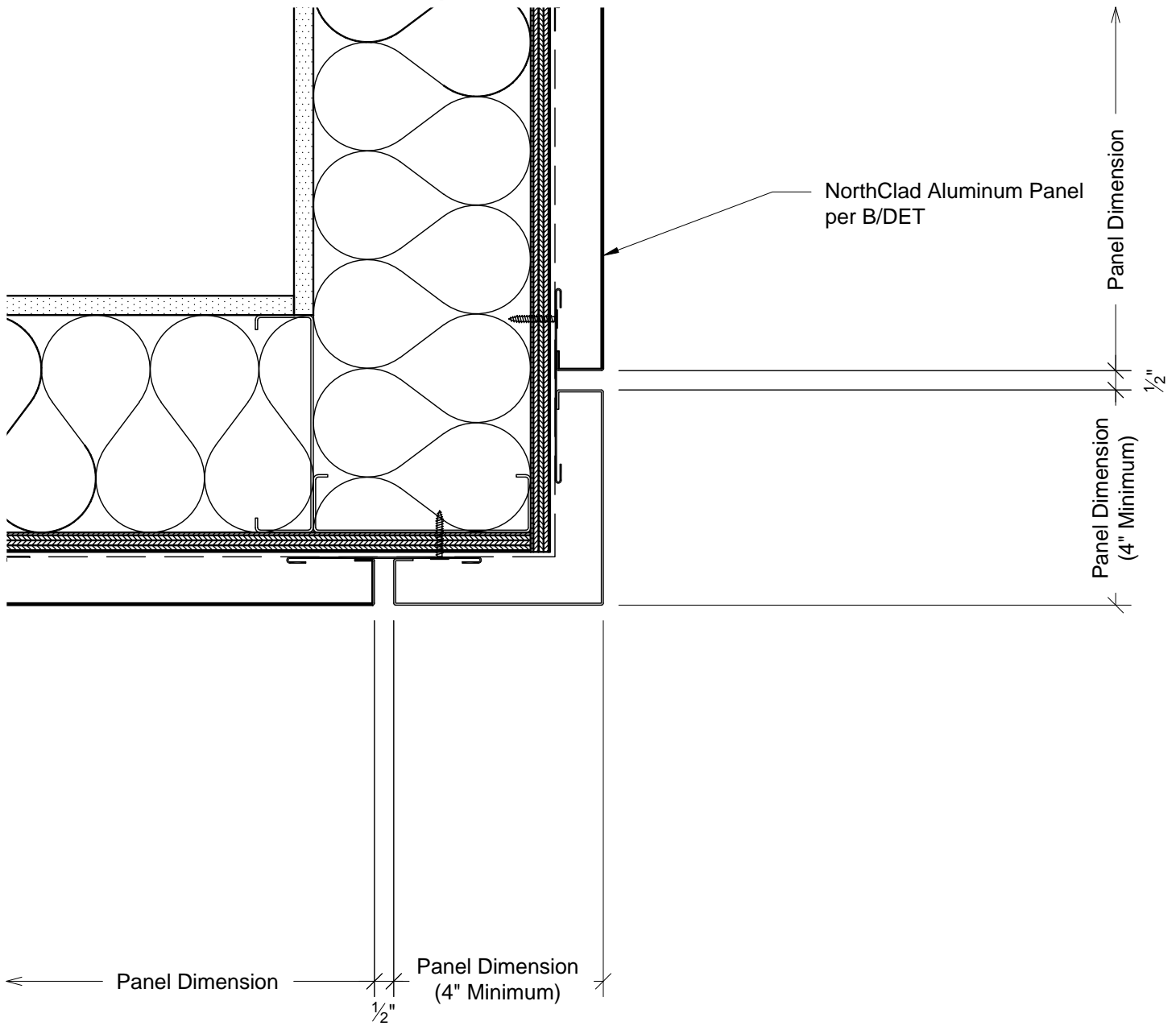

E1

Plan - Outside Corner without Trim
 System: AL Stacking with Inboard Insulation



11831 BEVERLY PARK RD. BUILDING C, EVERETT, WA 98204
 * PHONE: 425.740.3702 * FAX: 425.485.3503 *
 www.northclad.com

This document is property of NorthClad and should not be used, duplicated or modified without the express written consent. Copyright © 2010 NorthClad All Rights Reserved

NO.	DESCRIPTION	DATE	INIT.
1	Design	05/14/2018	M E
2	-	-	-
3	-	-	-
4	-	-	-
5	-	-	-
6	-	-	-
7	-	-	-
8	-	-	-
9	-	-	-
10	-	-	-

Project

NorthClad AL Stacking System

11831 Beverly Park Rd, Bldg C
 Everett, WA 98204

Category	DET
Scale	3" = 1'-0"
Job Number	NC0000
Sheet	E1
APPROVED	

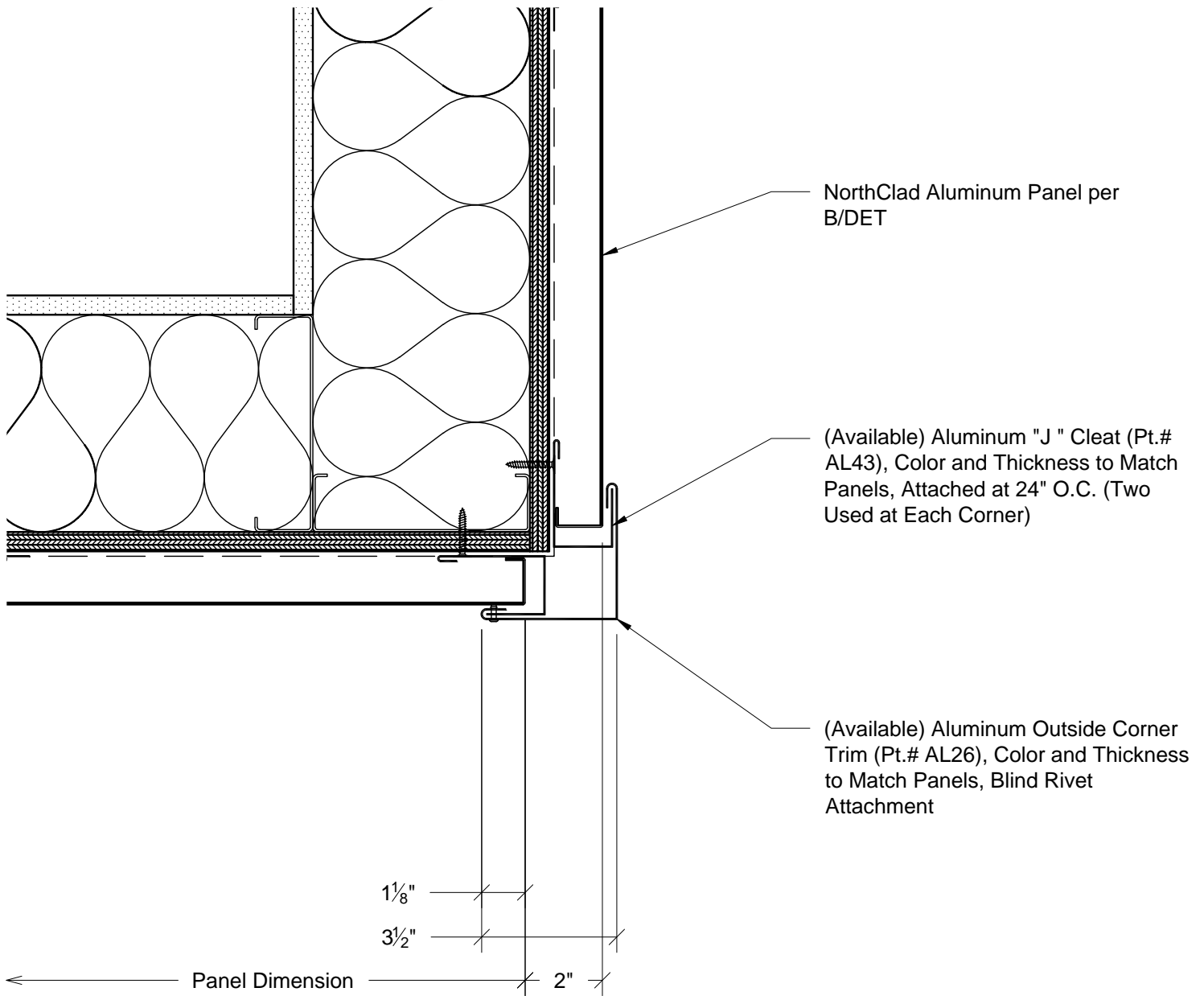

E2

Plan - Edge of Panels at Outside Corner with Trim
System: AL Stacking with Inboard Insulation



11831 BEVERLY PARK RD. BUILDING C, EVERETT, WA 98204
* PHONE: 425.740.3702 * FAX: 425.485.3503 *
www.northclad.com

This document is property of NorthClad and should not be used, duplicated or modified without the express written consent. Copyright © 2010 NorthClad All Rights Reserved

NO.	DESCRIPTION	DATE	INIT.
1	Design	05/14/2018	M E
2	-	-	-
3	-	-	-
4	-	-	-
5	-	-	-
6	-	-	-
7	-	-	-
8	-	-	-
9	-	-	-
10	-	-	-

Project

NorthClad AL Stacking System

11831 Beverly Park Rd, Bldg C
Everett, WA 98204

Category
DET

Scale
3" = 1'-0"

Job Number
NC0000

Sheet
E2

APPROVED

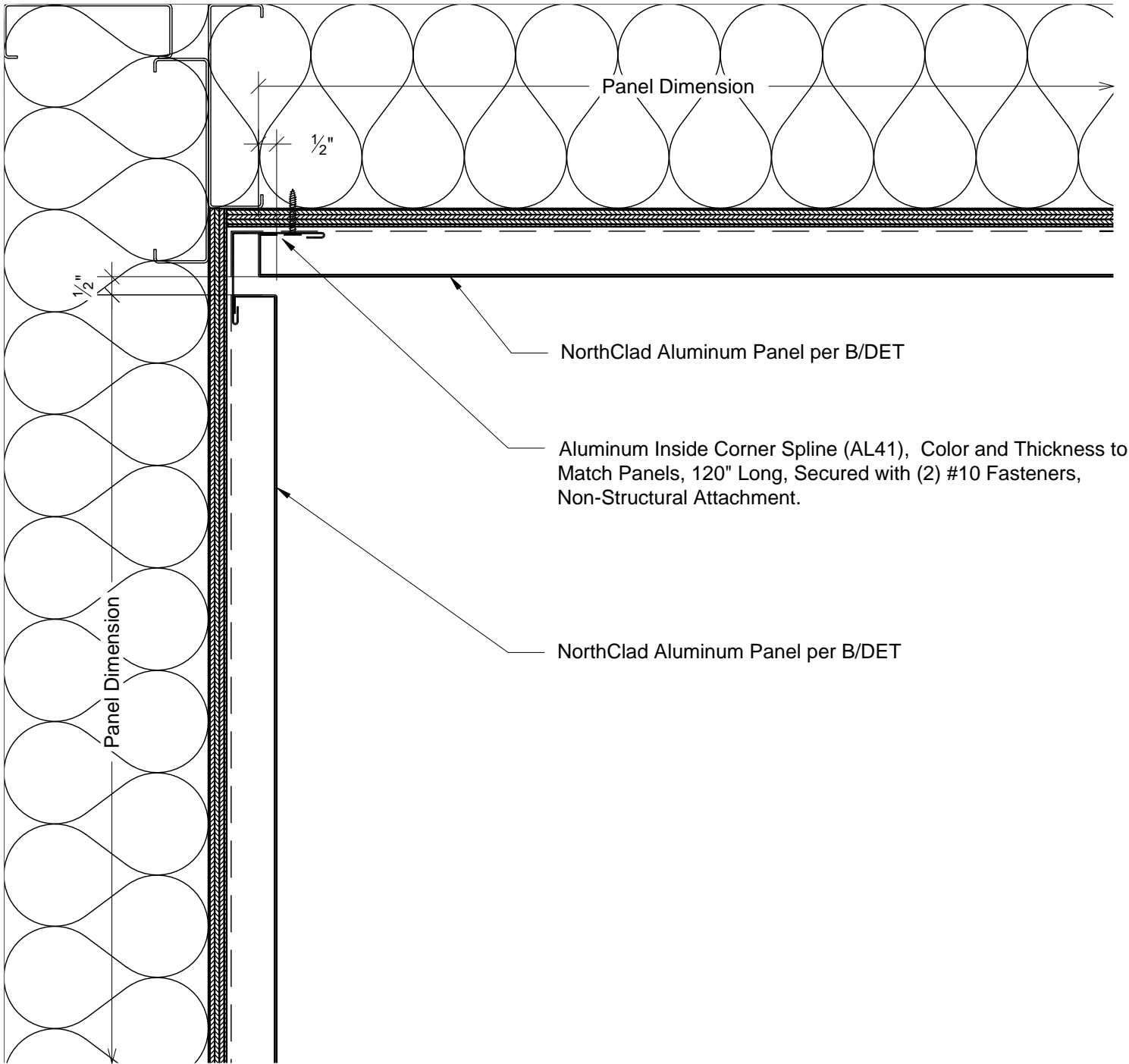

F1

Plan - Edge of Panels at Inside Corner without Trim
 System: AL Stacking with Inboard Insulation



11831 BEVERLY PARK RD. BUILDING C, EVERETT, WA 98204
 * PHONE: 425.740.3702 * FAX: 425.485.3503 *
 www.northclad.com

This document is property of NorthClad and should not be used, duplicated or modified without the express written consent. Copyright © 2010 NorthClad All Rights Reserved

NO.	DESCRIPTION	DATE	INIT.
1	Design	05/14/2018	ME
2	-	-	-
3	-	-	-
4	-	-	-
5	-	-	-
6	-	-	-
7	-	-	-
8	-	-	-
9	-	-	-
10	-	-	-

Project

NorthClad AL Stacking System

11831 Beverly Park Rd, Bldg C
 Everett, WA 98204

Category
 DET

Scale
 3" = 1'-0"

Job Number
 NC0000

Sheet
 F1

APPROVED

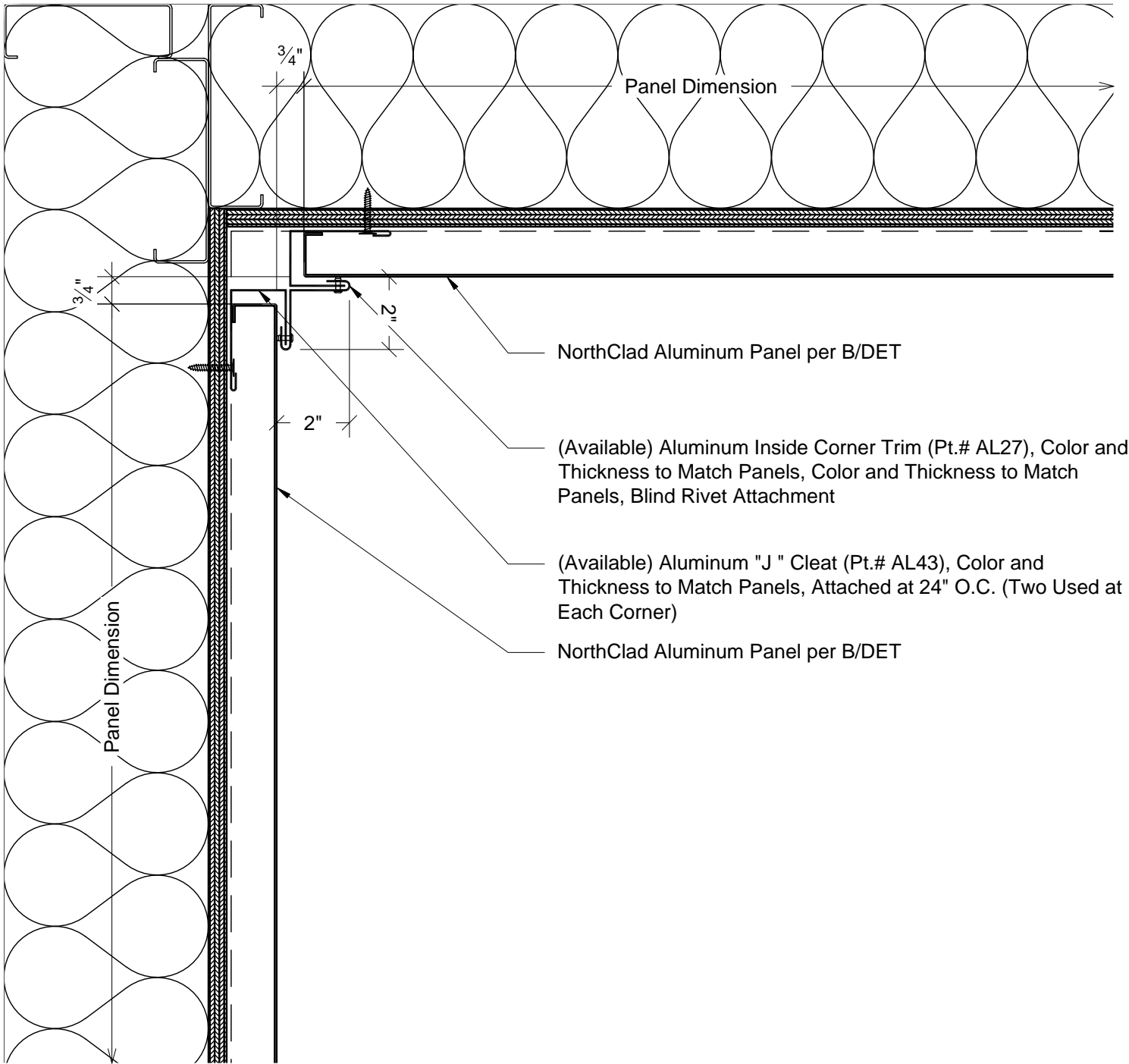

F2

Plan - Edge of Panels at Inside Corner with Trim
 System: AL Stacking with Inboard Insulation



11831 BEVERLY PARK RD. BUILDING C, EVERETT, WA 98204
 * PHONE: 425.740.3702 * FAX: 425.485.3503 *
 www.northclad.com

This document is property of NorthClad and should not be used, duplicated or modified without the express written consent. Copyright © 2010 NorthClad All Rights Reserved

NO.	DESCRIPTION	DATE	INIT.
1	Design	05/14/2018	M E
2	-	-	-
3	-	-	-
4	-	-	-
5	-	-	-
6	-	-	-
7	-	-	-
8	-	-	-
9	-	-	-
10	-	-	-

Project

NorthClad AL Stacking System

11831 Beverly Park Rd, Bldg C
 Everett, WA 98204

Category
 DET

Scale
 3" = 1'-0"

Job Number
 NC0000

Sheet
 F2

APPROVED

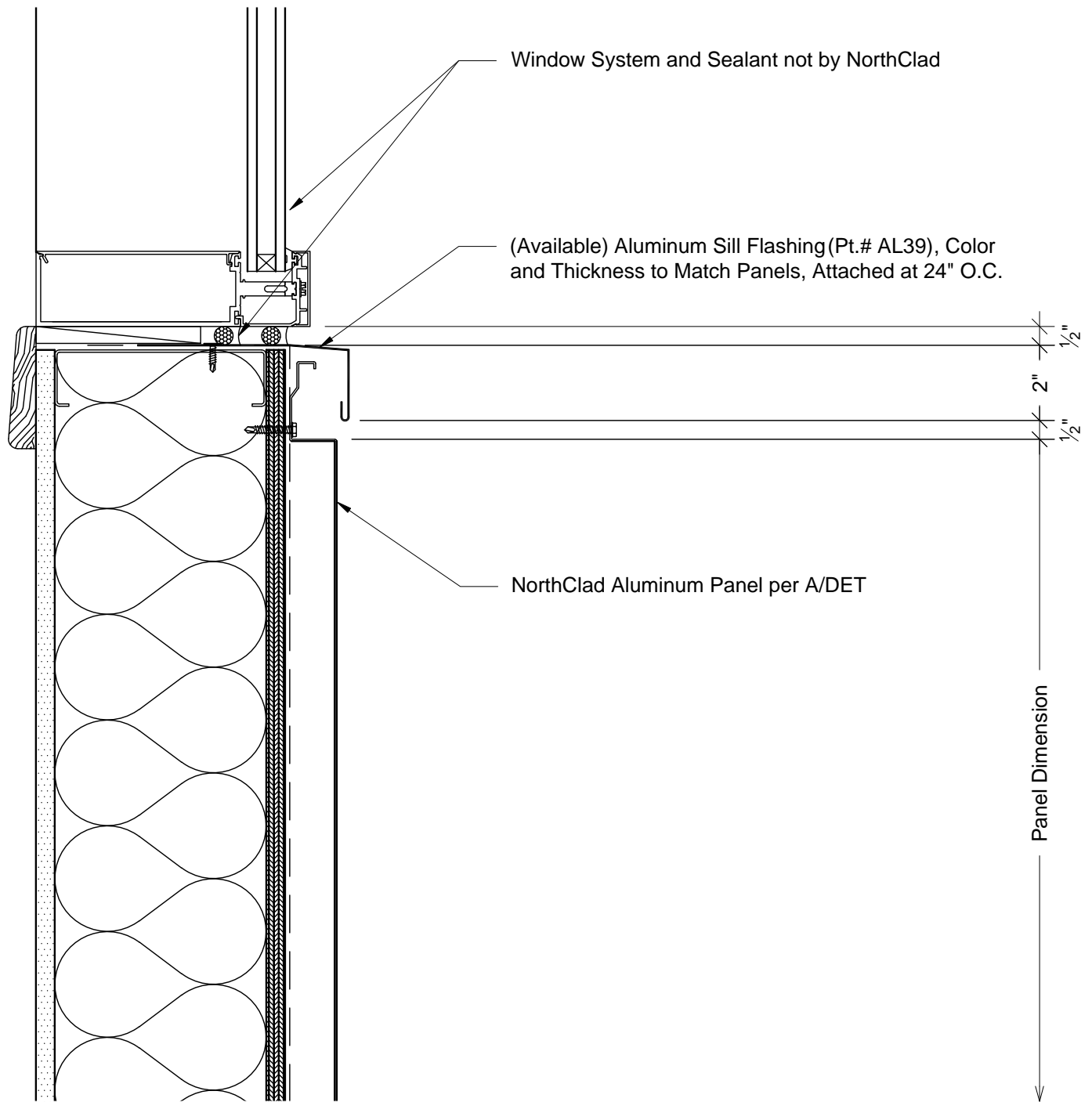

G1 Section - Top of Panel at Window Sill
System: AL Stacking with Inboard Insulation



11831 BEVERLY PARK RD. BUILDING C, EVERETT, WA 98204
* PHONE: 425.740.3702 * FAX: 425.485.3503 *
www.northclad.com

This document is property of NorthClad and should not be used, duplicated or modified without the express written consent. Copyright © 2010 NorthClad All Rights Reserved

NO.	DESCRIPTION	DATE	INIT.
1	Design	05/14/2018	ME
2	-	-	-
3	-	-	-
4	-	-	-
5	-	-	-
6	-	-	-
7	-	-	-
8	-	-	-
9	-	-	-
10	-	-	-

Project

NorthClad AL Stacking System

11831 Beverly Park Rd, Bldg C
Everett, WA 98204

Category	DET
Scale	3" = 1'-0"
Job Number	NC0000
Sheet	G1
APPROVED	

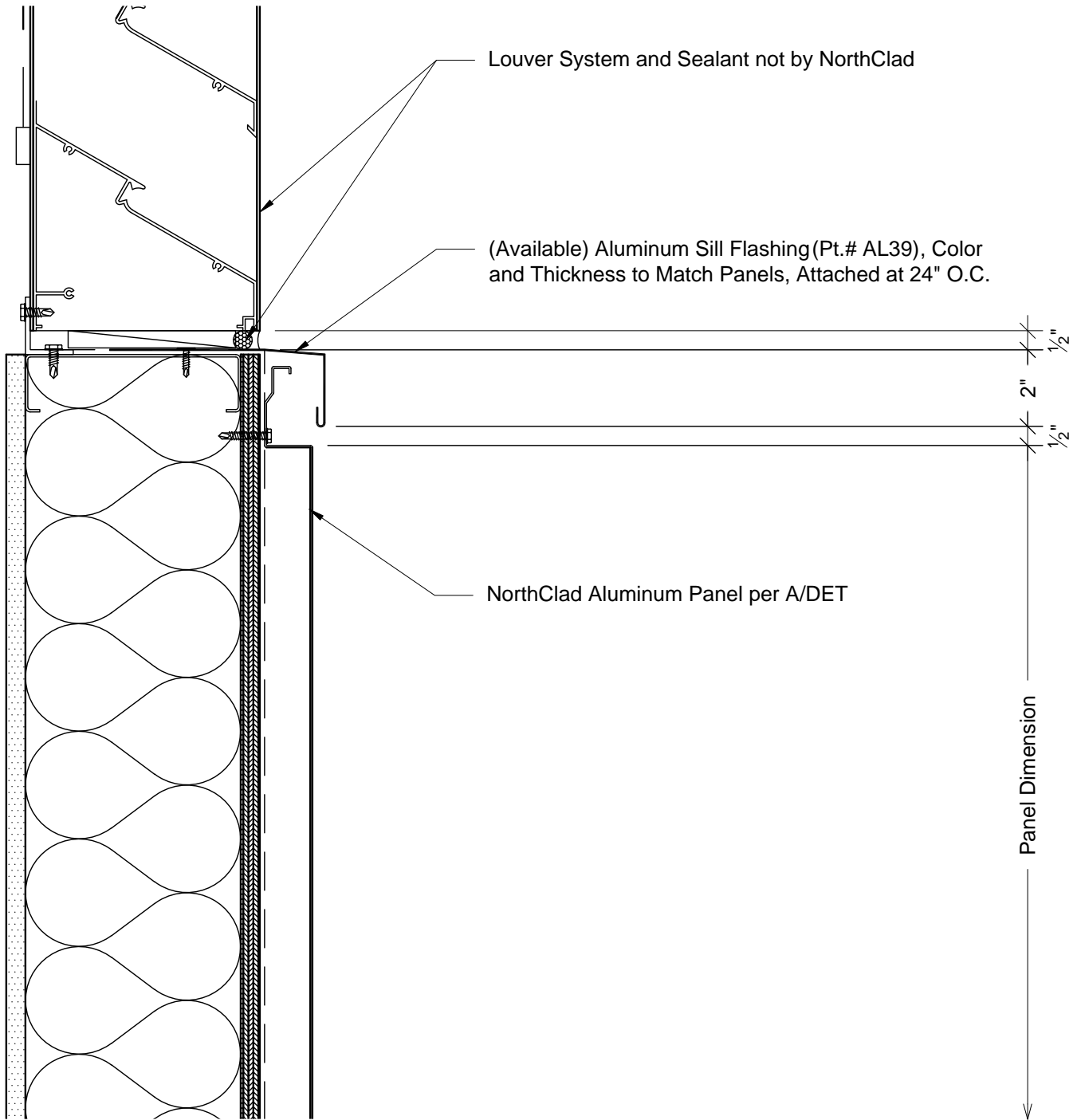

G2 Section - Top of Panel at Louver Sill
System: AL Stacking with Inboard Insulation



11831 BEVERLY PARK RD. BUILDING C, EVERETT, WA 98204
* PHONE: 425.740.3702 * FAX: 425.485.3503 *
www.northclad.com

This document is property of NorthClad and should not be used, duplicated or modified without the express written consent. Copyright © 2010 NorthClad All Rights Reserved

NO.	DESCRIPTION	DATE	INIT.
1	Design	05/14/2018	ME
2	-	-	-
3	-	-	-
4	-	-	-
5	-	-	-
6	-	-	-
7	-	-	-
8	-	-	-
9	-	-	-
10	-	-	-

Project

NorthClad AL Stacking System

11831 Beverly Park Rd, Bldg C
Everett, WA 98204

Category	DET
Scale	3" = 1'-0"
Job Number	NC0000
Sheet	G2
APPROVED	

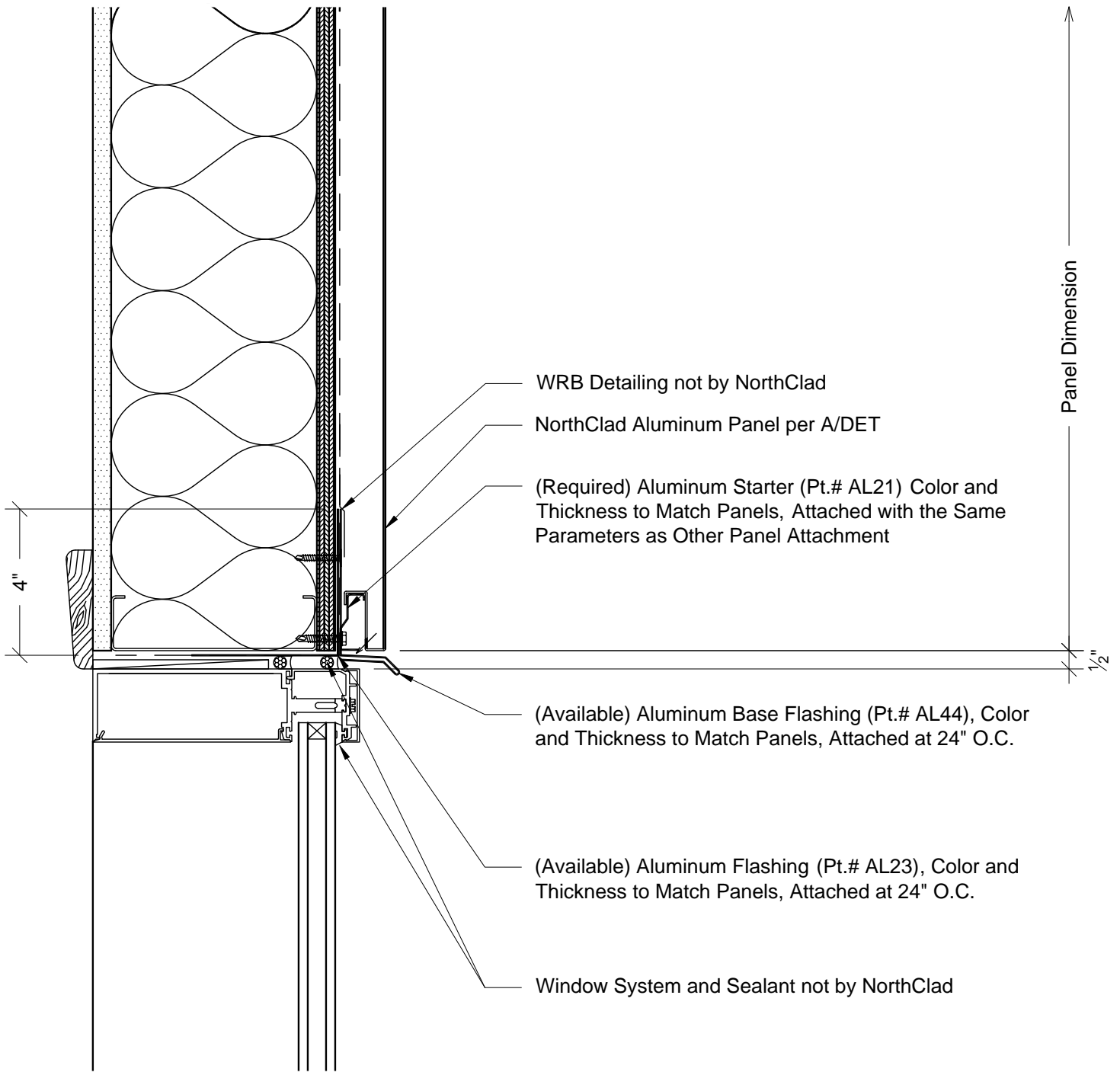

H1

Section - Bottom of Panel at Window Head
System: AL Stacking with Inboard Insulation



11831 BEVERLY PARK RD. BUILDING C, EVERETT, WA 98204
* PHONE: 425.740.3702 * FAX: 425.485.3503 *
www.northclad.com

This document is property of NorthClad and should not be used, duplicated or modified without the express written consent. Copyright © 2010 NorthClad All Rights Reserved

NO.	DESCRIPTION	DATE	INIT.
1	Design	05/14/2018	M E
2	-	-	-
3	-	-	-
4	-	-	-
5	-	-	-
6	-	-	-
7	-	-	-
8	-	-	-
9	-	-	-
10	-	-	-

Project

NorthClad AL Stacking System

11831 Beverly Park Rd, Bldg C
Everett, WA 98204

Category	DET
Scale	3" = 1'-0"
Job Number	NC0000
Sheet	H1
APPROVED	

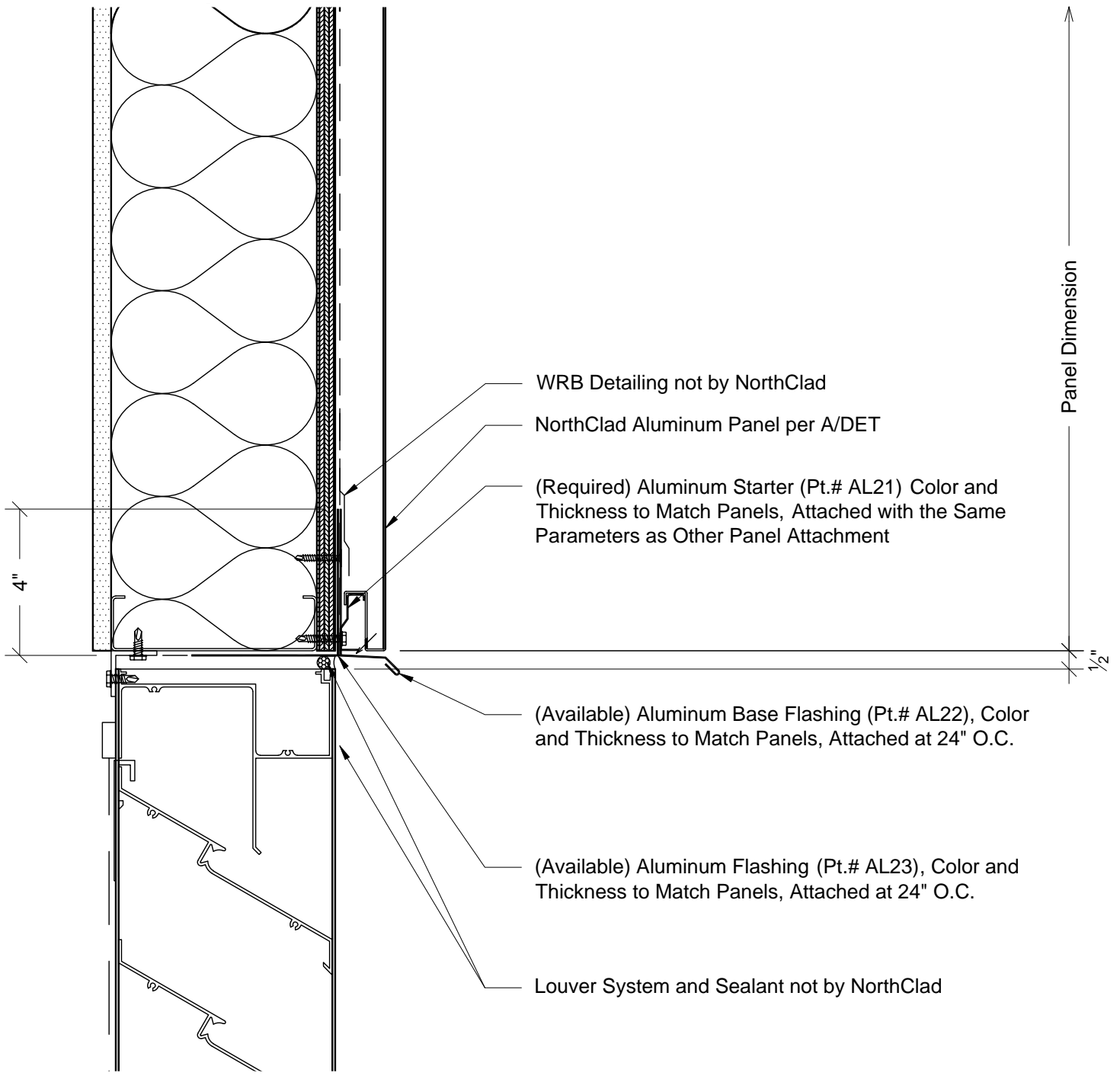

H2 Section - Bottom of Panel at Louver Head
 System: AL Stacking with Inboard Insulation



11831 BEVERLY PARK RD. BUILDING C, EVERETT, WA 98204
 * PHONE: 425.740.3702 * FAX: 425.485.3503 *
 www.northclad.com

This document is property of NorthClad and should not be used, duplicated or modified without the express written consent. Copyright © 2010 NorthClad All Rights Reserved

NO.	DESCRIPTION	DATE	INIT.
1	Design	05/14/2018	M E
2	-	-	-
3	-	-	-
4	-	-	-
5	-	-	-
6	-	-	-
7	-	-	-
8	-	-	-
9	-	-	-
10	-	-	-

Project
NorthClad AL Stacking System
 11831 Beverly Park Rd, Bldg C
 Everett, WA 98204

Category	DET
Scale	3" = 1'-0"
Job Number	NC0000
Sheet	H2
APPROVED	

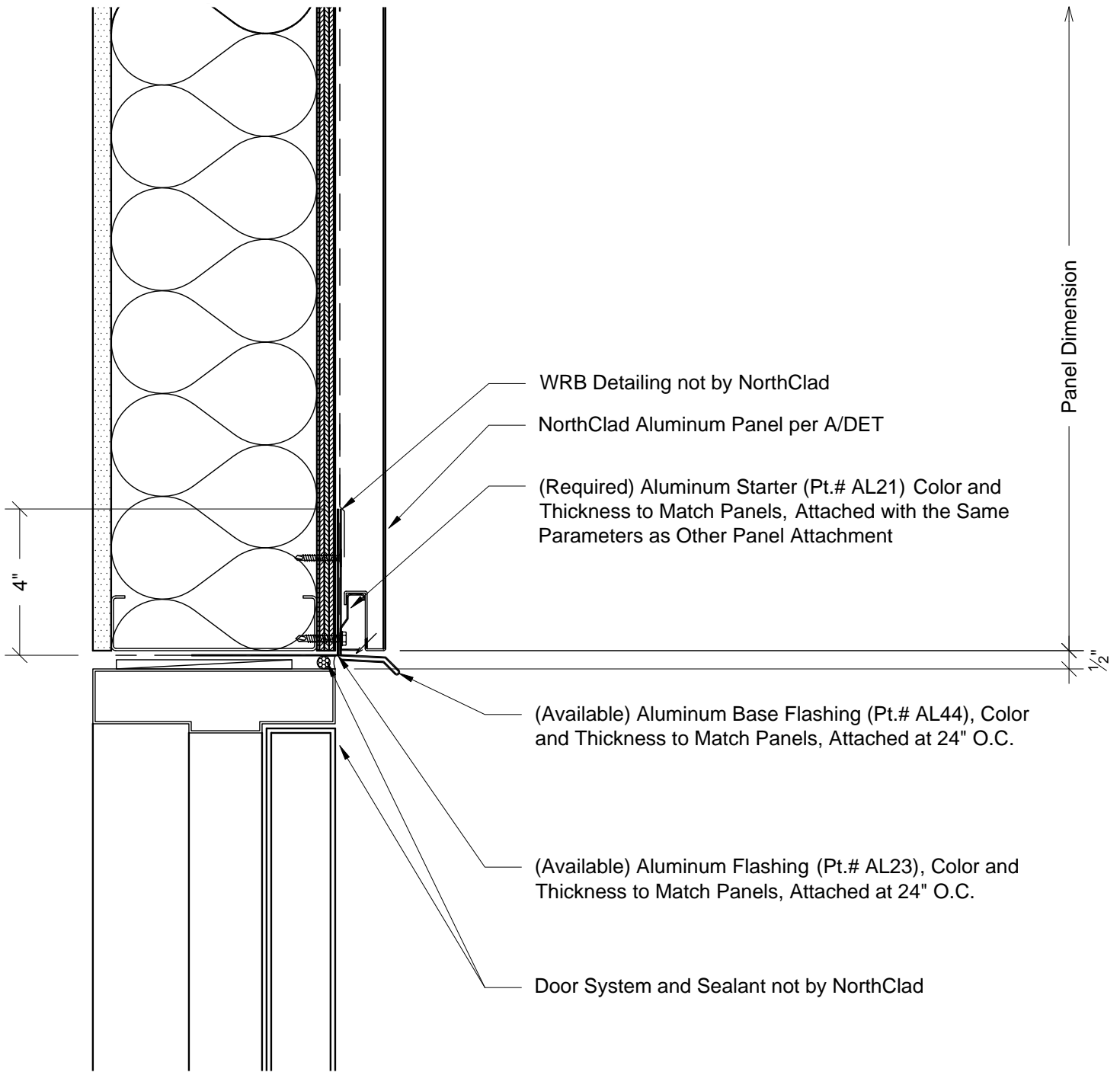

H3 Section - Bottom of Panel at Door Head
System: AL Stacking with Inboard Insulation



11831 BEVERLY PARK RD. BUILDING C, EVERETT, WA 98204
* PHONE: 425.740.3702 * FAX: 425.485.3503 *
www.northclad.com

This document is property of NorthClad and should not be used, duplicated or modified without the express written consent. Copyright © 2010 NorthClad All Rights Reserved

NO.	DESCRIPTION	DATE	INIT.
1	Design	05/14/2018	M E
2	-	-	-
3	-	-	-
4	-	-	-
5	-	-	-
6	-	-	-
7	-	-	-
8	-	-	-
9	-	-	-
10	-	-	-

Project

NorthClad AL Stacking System

11831 Beverly Park Rd, Bldg C
Everett, WA 98204

Category	DET
Scale	3" = 1'-0"
Job Number	NC0000
Sheet	H3
APPROVED	

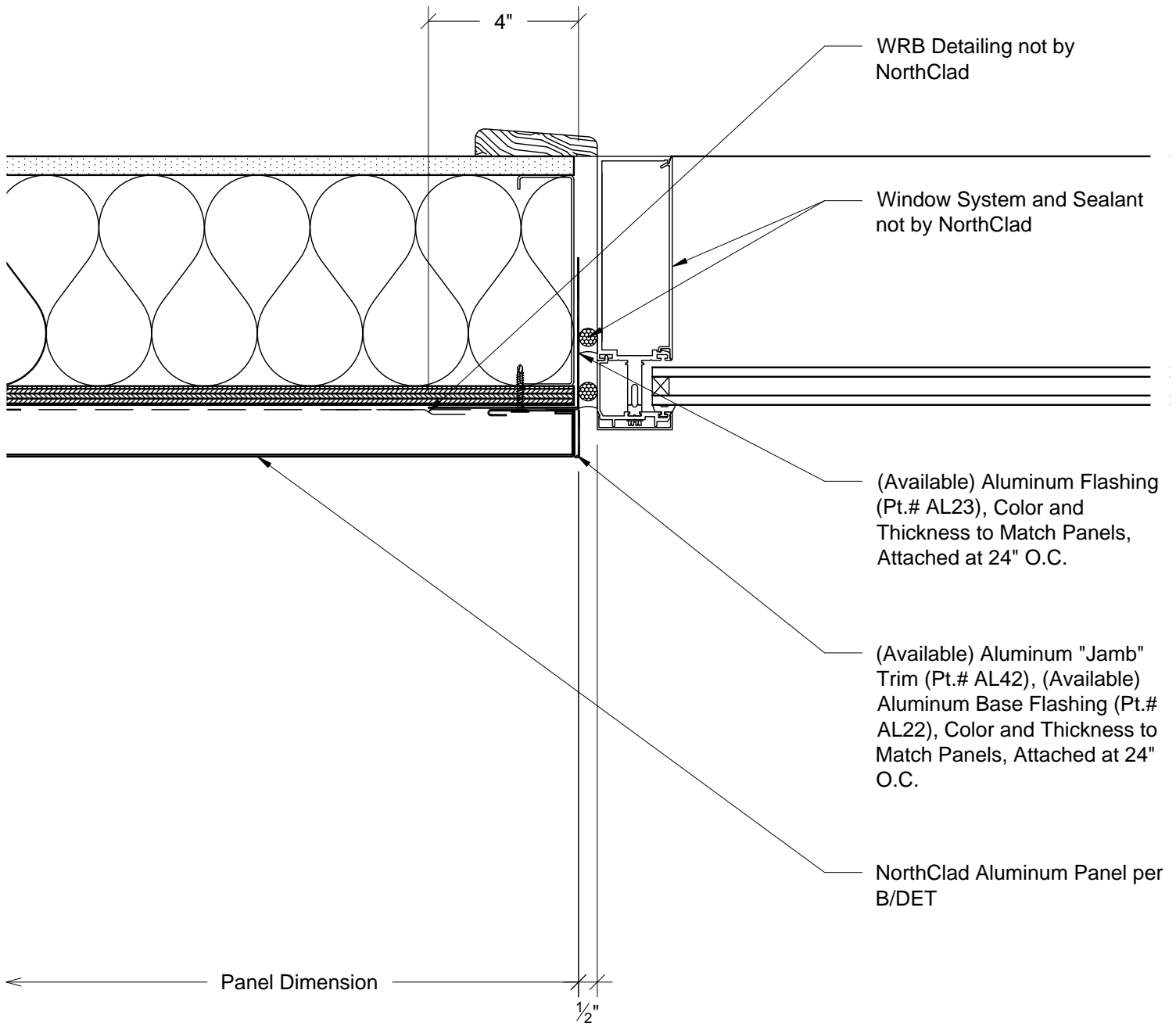

J1

Plan - Right Edge of Panel at Window Jamb
System: AL Stacking with Inboard Insulation



11831 BEVERLY PARK RD. BUILDING C, EVERETT, WA 98204
* PHONE: 425.740.3702 * FAX: 425.485.3503 *
www.northclad.com

This document is property of NorthClad and should not be used, duplicated or modified without the express written consent. Copyright © 2010 NorthClad All Rights Reserved

NO.	DESCRIPTION	DATE	INIT.
1	Design	05/14/2018	M E
2	-	-	-
3	-	-	-
4	-	-	-
5	-	-	-
6	-	-	-
7	-	-	-
8	-	-	-
9	-	-	-
10	-	-	-

Project

NorthClad AL Stacking System

11831 Beverly Park Rd, Bldg C
Everett, WA 98204

Category	DET
Scale	3" = 1'-0"
Job Number	NC0000
Sheet	J1
APPROVED	

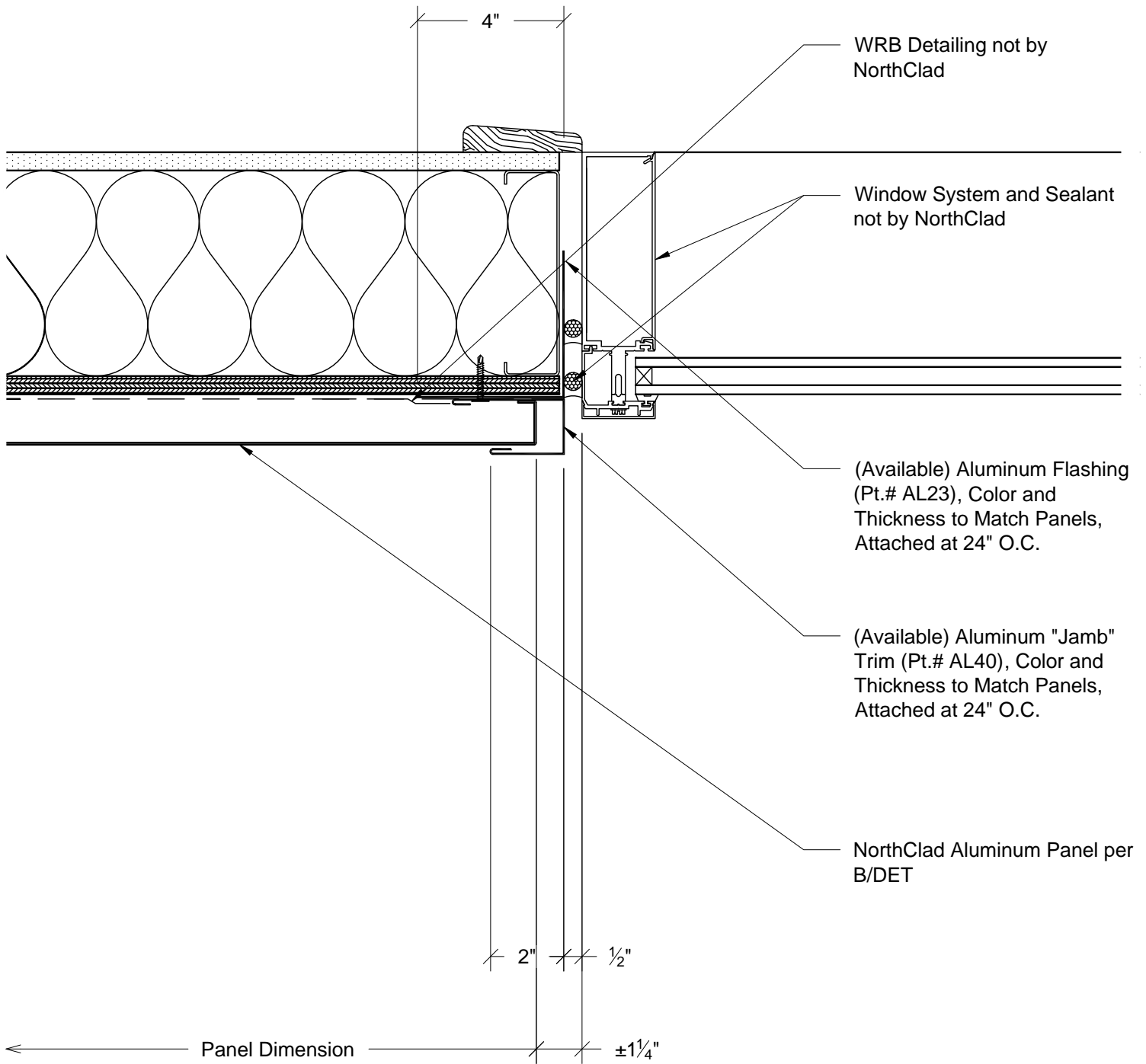

J1

Plan - Right Edge of Panel at Window Jamb
System: AL Stacking with Inboard Insulation



11831 BEVERLY PARK RD. BUILDING C, EVERETT, WA 98204
* PHONE: 425.740.3702 * FAX: 425.485.3503 *
www.northclad.com

This document is property of NorthClad and should not be used, duplicated or modified without the express written consent. Copyright © 2010 NorthClad All Rights Reserved

NO.	DESCRIPTION	DATE	INIT.
1	Design	05/14/2018	M E
2	-	-	-
3	-	-	-
4	-	-	-
5	-	-	-
6	-	-	-
7	-	-	-
8	-	-	-
9	-	-	-
10	-	-	-

Project

NorthClad AL Stacking System

11831 Beverly Park Rd, Bldg C
Everett, WA 98204

Category

ALT

Scale

3" = 1'-0"

Job Number

NC0000

Sheet

J1

APPROVED

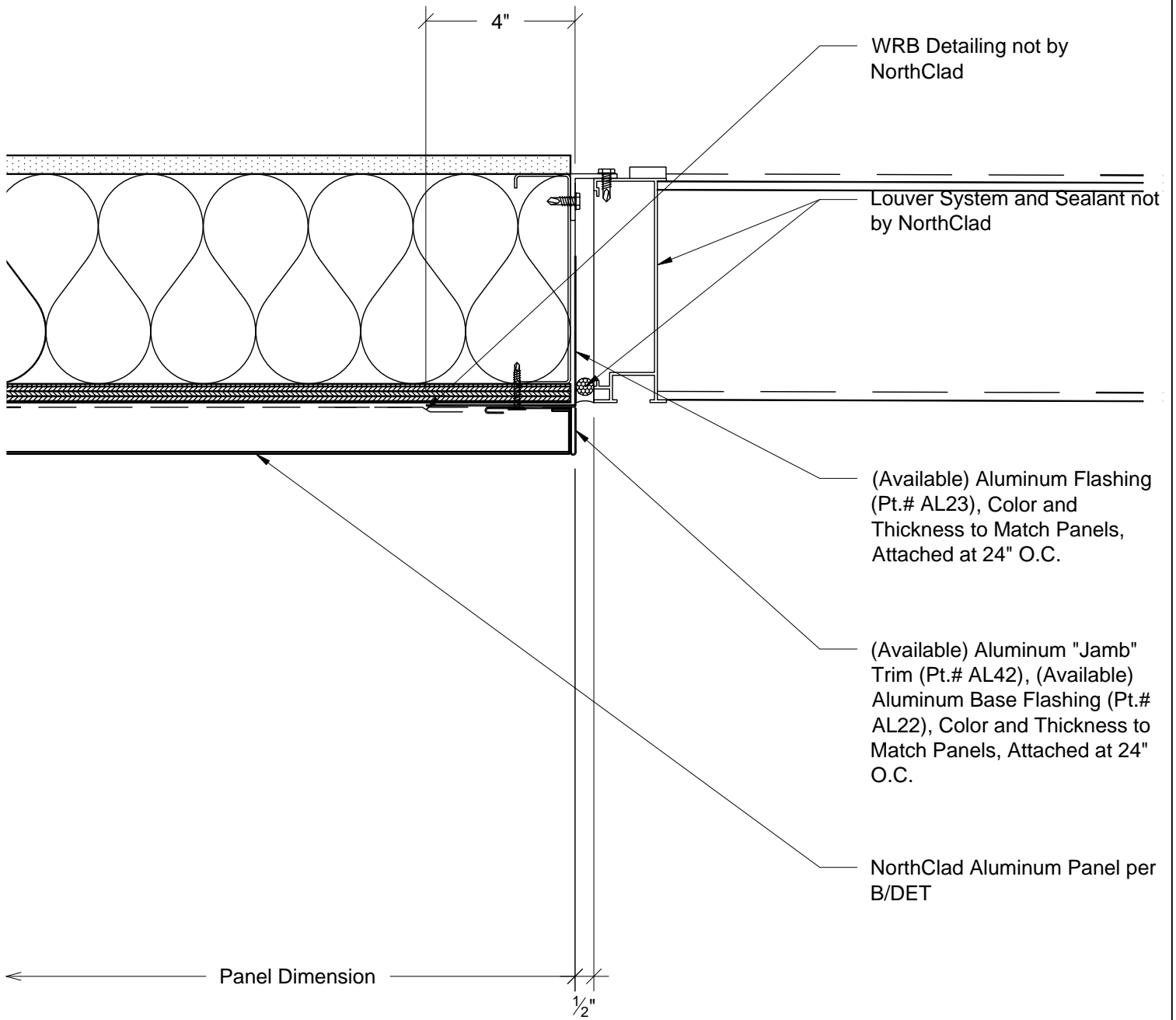

J2

Plan - Right Edge of Panel at Louver Jamb
System: AL Stacking with Inboard Insulation



11831 BEVERLY PARK RD. BUILDING C, EVERETT, WA 98204
* PHONE: 425.740.3702 * FAX: 425.485.3503 *
www.northclad.com

This document is property of NorthClad and should not be used, duplicated or modified without the express written consent. Copyright © 2010 NorthClad All Rights Reserved

NO.	DESCRIPTION	DATE	INIT.
1	Design	05/14/2018	M E
2	-	-	-
3	-	-	-
4	-	-	-
5	-	-	-
6	-	-	-
7	-	-	-
8	-	-	-
9	-	-	-
10	-	-	-

Project

NorthClad AL Stacking System

11831 Beverly Park Rd, Bldg C
Everett, WA 98204

Category	DET
Scale	3" = 1'-0"
Job Number	NC0000
Sheet	J2
APPROVED	

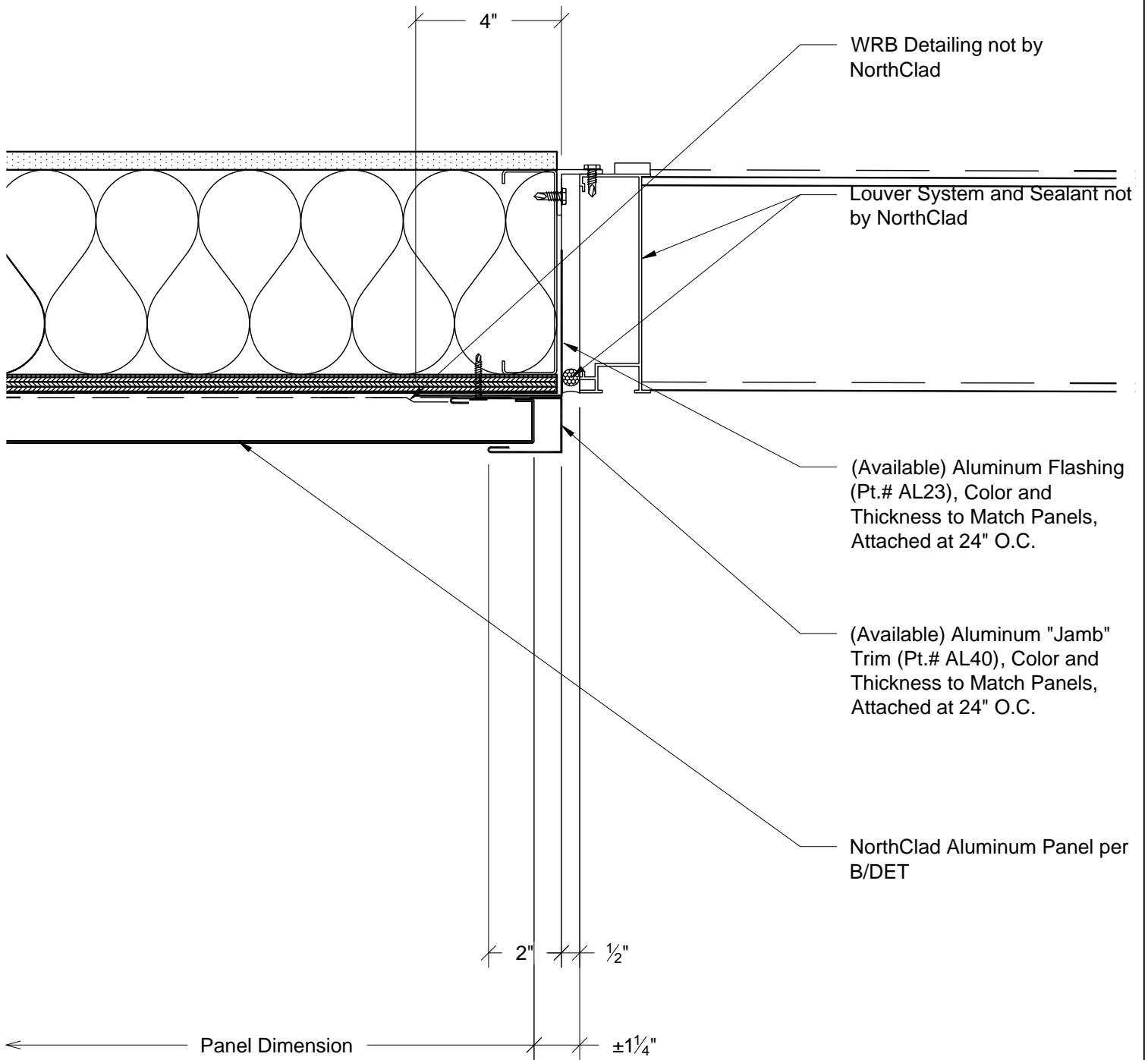

J2

Plan - Right Edge of Panel at Louver Jamb
System: AL Stacking with Inboard Insulation



11831 BEVERLY PARK RD. BUILDING C, EVERETT, WA 98204
* PHONE: 425.740.3702 * FAX: 425.485.3503 *
www.northclad.com

This document is property of NorthClad and should not be used, duplicated or modified without the express written consent. Copyright © 2010 NorthClad All Rights Reserved

NO.	DESCRIPTION	DATE	INIT.
1	Design	05/14/2018	M E
2	-	-	-
3	-	-	-
4	-	-	-
5	-	-	-
6	-	-	-
7	-	-	-
8	-	-	-
9	-	-	-
10	-	-	-

Project

NorthClad AL Stacking System

11831 Beverly Park Rd, Bldg C
Everett, WA 98204

Category	ALT
Scale	3" = 1'-0"
Job Number	NC0000
Sheet	J2
APPROVED	

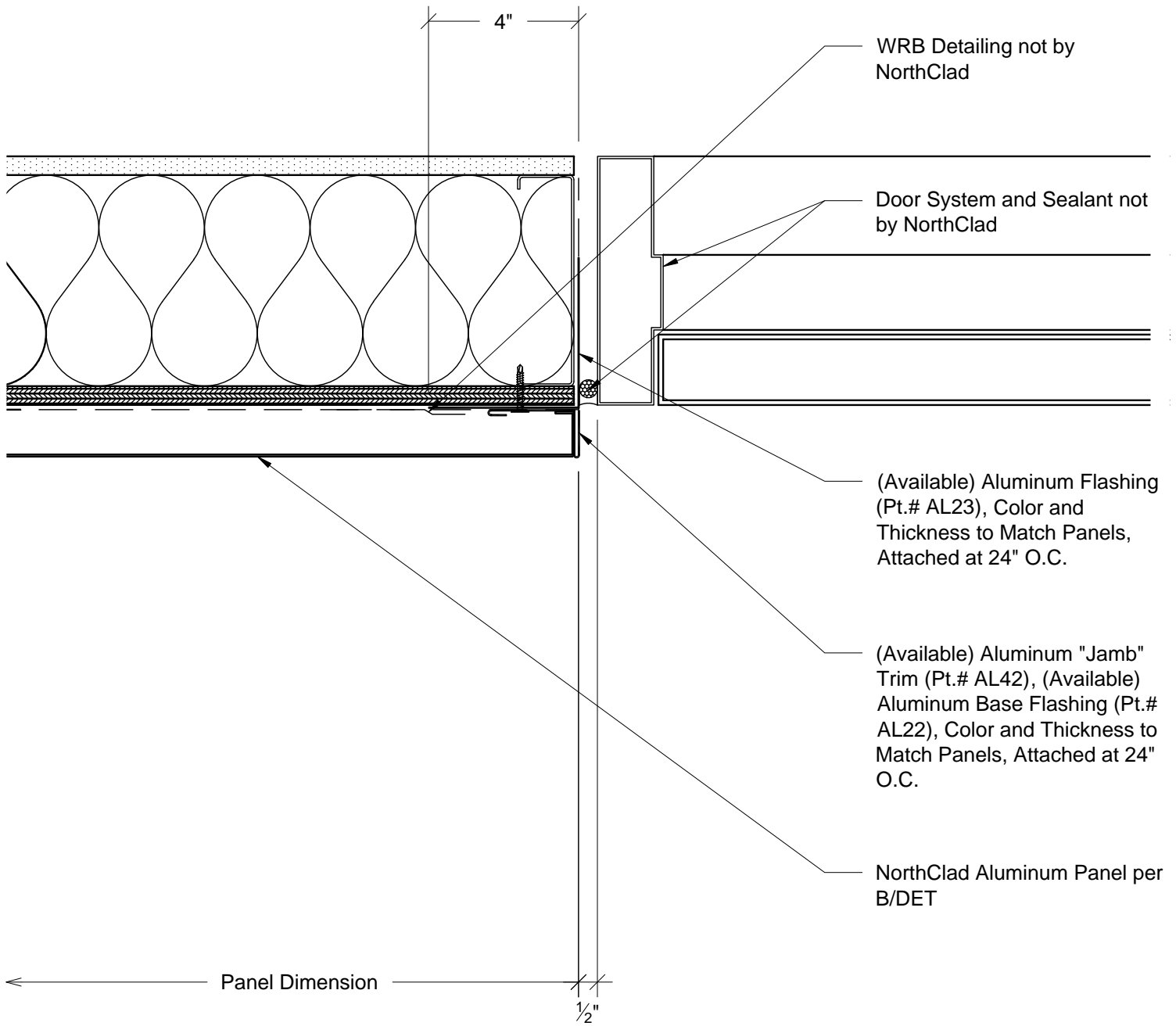

J3

Plan - Right Edge of Panel at Door Jamb
System: AL Stacking with Inboard Insulation



11831 BEVERLY PARK RD. BUILDING C, EVERETT, WA 98204
* PHONE: 425.740.3702 * FAX: 425.485.3503 *
www.northclad.com

This document is property of NorthClad and should not be used, duplicated or modified without the express written consent. Copyright © 2010 NorthClad All Rights Reserved

NO.	DESCRIPTION	DATE	INIT.
1	Design	05/14/2018	ME
2	-	-	-
3	-	-	-
4	-	-	-
5	-	-	-
6	-	-	-
7	-	-	-
8	-	-	-
9	-	-	-
10	-	-	-

Project

NorthClad AL Stacking System

11831 Beverly Park Rd, Bldg C
Everett, WA 98204

Category
DET

Scale
3" = 1'-0"

Job Number
NC0000

Sheet
J3

APPROVED

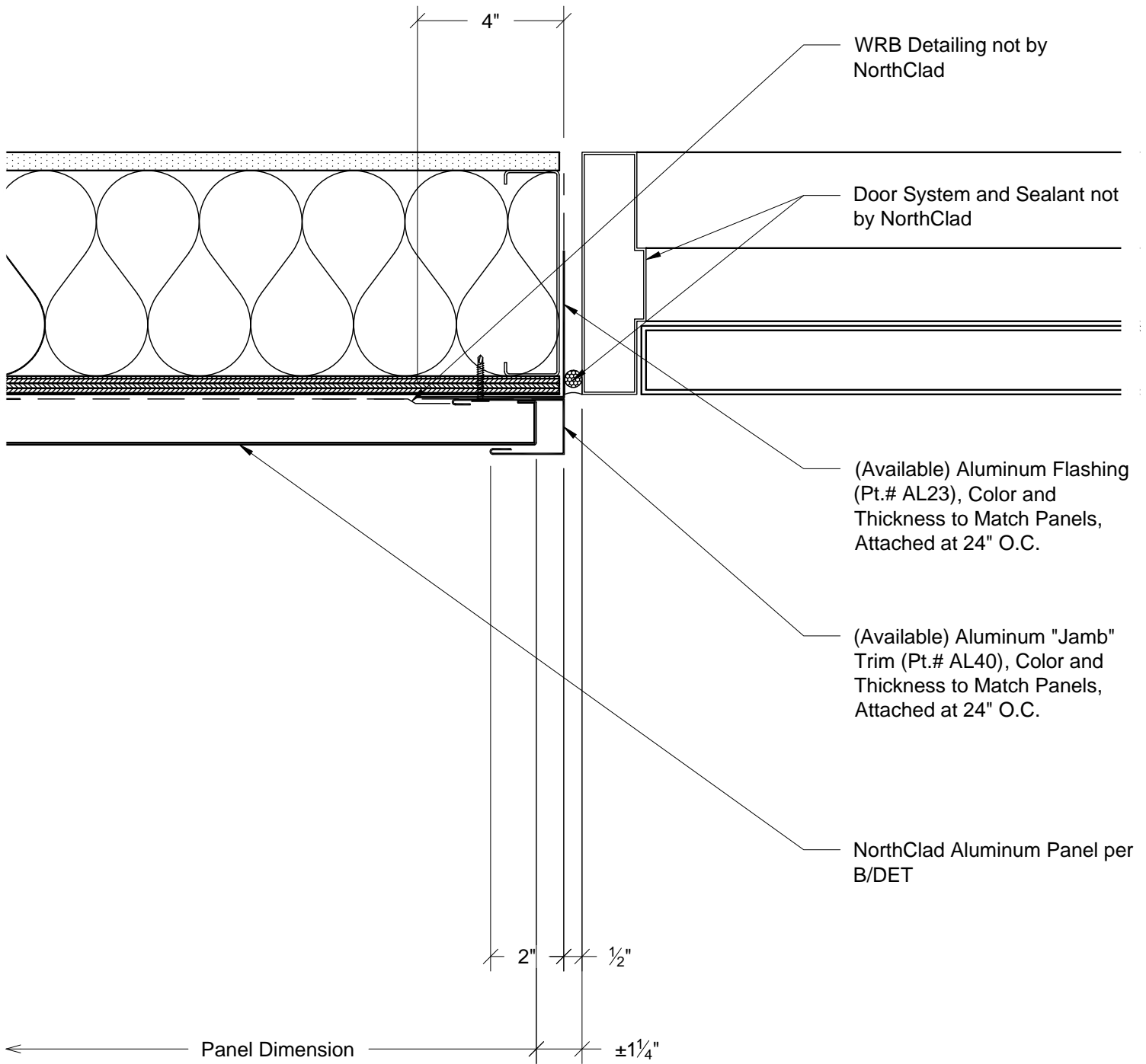

J3

Plan - Right Edge of Panel at Door Jamb
System: AL Stacking with Inboard Insulation



11831 BEVERLY PARK RD. BUILDING C, EVERETT, WA 98204
* PHONE: 425.740.3702 * FAX: 425.485.3503 *
www.northclad.com

This document is property of NorthClad and should not be used, duplicated or modified without the express written consent. Copyright © 2010 NorthClad All Rights Reserved

NO.	DESCRIPTION	DATE	INIT.
1	Design	05/14/2018	M E
2	-	-	-
3	-	-	-
4	-	-	-
5	-	-	-
6	-	-	-
7	-	-	-
8	-	-	-
9	-	-	-
10	-	-	-

Project

NorthClad AL Stacking System

11831 Beverly Park Rd, Bldg C
Everett, WA 98204

Category	ALT
Scale	3" = 1'-0"
Job Number	NC0000
Sheet	J3
APPROVED	

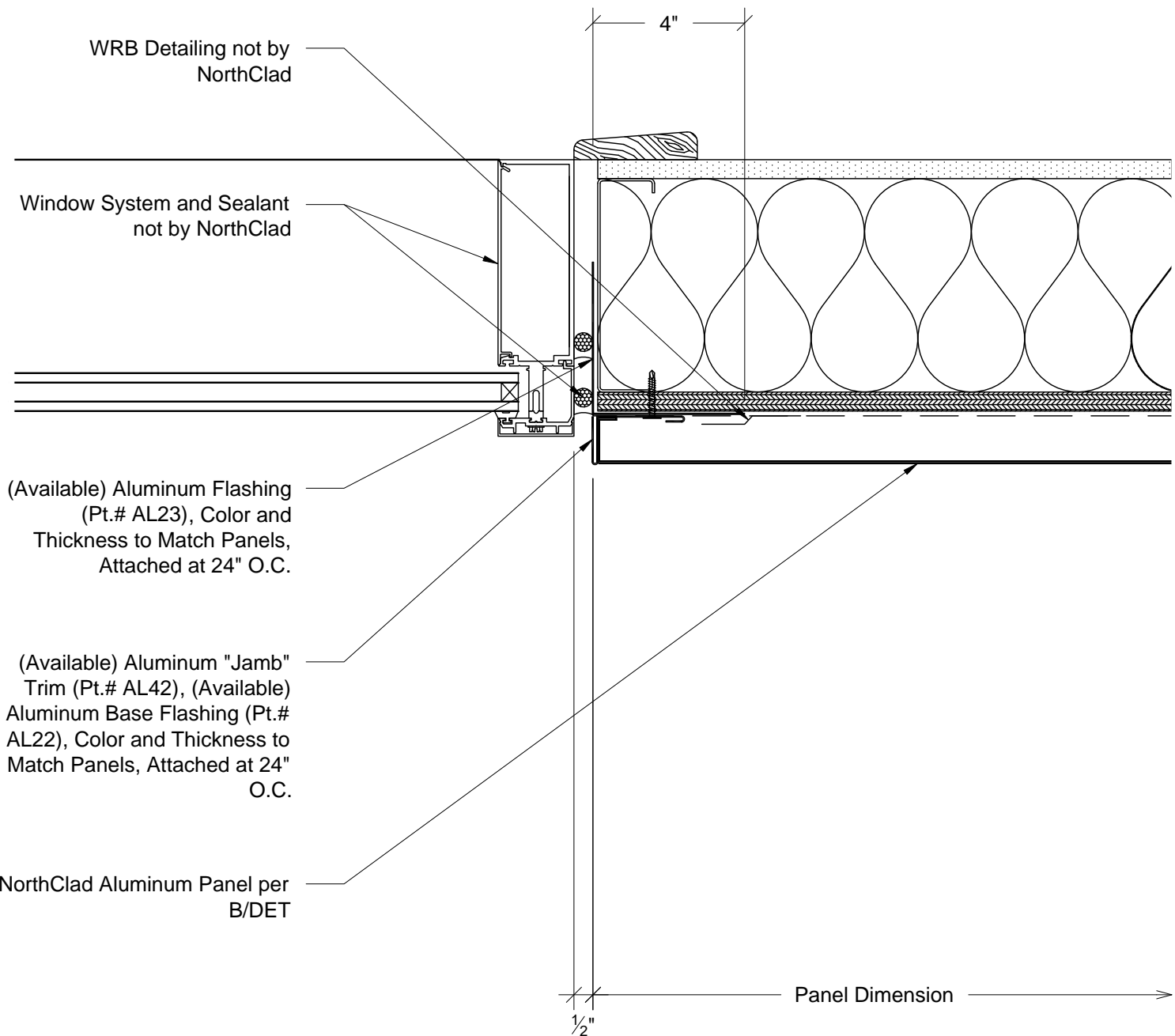

K1

Plan - Left Edge of Panel at Window Jamb
System: AL Stacking with Inboard Insulation



11831 BEVERLY PARK RD. BUILDING C, EVERETT, WA 98204
* PHONE: 425.740.3702 * FAX: 425.485.3503 *
www.northclad.com

This document is property of NorthClad and should not be used, duplicated or modified without the express written consent. Copyright © 2010 NorthClad All Rights Reserved

NO.	DESCRIPTION	DATE	INIT.
1	Design	05/14/2018	M E
2	-	-	-
3	-	-	-
4	-	-	-
5	-	-	-
6	-	-	-
7	-	-	-
8	-	-	-
9	-	-	-
10	-	-	-

Project

NorthClad AL Stacking System

11831 Beverly Park Rd, Bldg C
Everett, WA 98204

Category: DET

Scale: 3" = 1'-0"

Job Number: NC0000

Sheet: K1

APPROVED

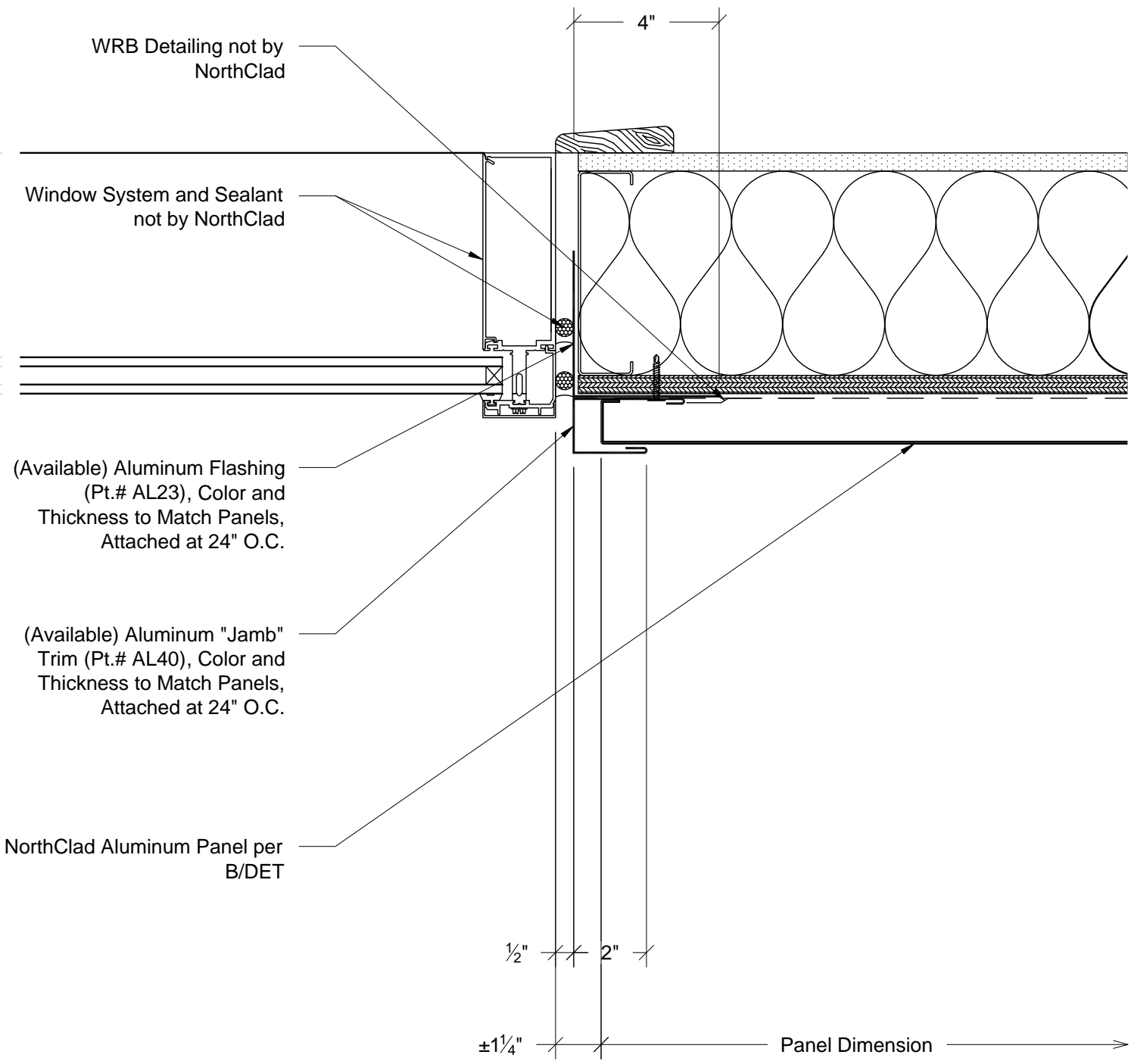

K1

Plan - Left Edge of Panel at Window Jamb
System: AL Stacking with Inboard Insulation



11831 BEVERLY PARK RD. BUILDING C, EVERETT, WA 98204
* PHONE: 425.740.3702 * FAX: 425.485.3503 *
www.northclad.com

This document is property of NorthClad and should not be used, duplicated or modified without the express written consent. Copyright © 2010 NorthClad All Rights Reserved

NO.	DESCRIPTION	DATE	INIT.
1	Design	05/14/2018	M E
2	-	-	-
3	-	-	-
4	-	-	-
5	-	-	-
6	-	-	-
7	-	-	-
8	-	-	-
9	-	-	-
10	-	-	-

Project

NorthClad AL Stacking System

11831 Beverly Park Rd, Bldg C
Everett, WA 98204

Category: ALT

Scale: 3" = 1'-0"

Job Number: NC0000

Sheet: K1

APPROVED

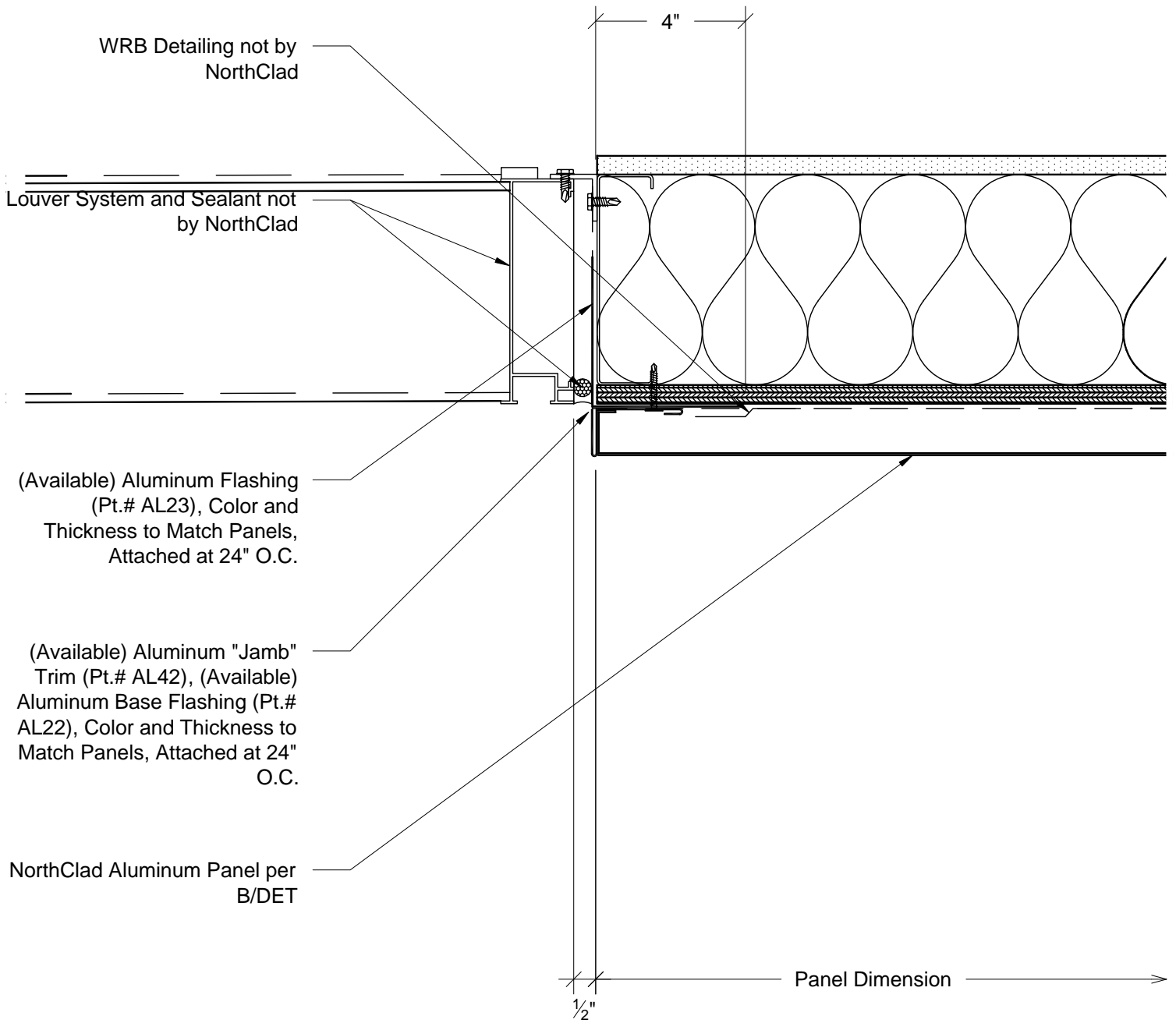

K2

Plan - Left Edge of Panel at Louver Jamb
System: AL Stacking with Inboard Insulation



11831 BEVERLY PARK RD. BUILDING C, EVERETT, WA 98204
* PHONE: 425.740.3702 * FAX: 425.485.3503 *
www.northclad.com

This document is property of NorthClad and should not be used, duplicated or modified without the express written consent. Copyright © 2010 NorthClad All Rights Reserved

NO.	DESCRIPTION	DATE	INIT.
1	Design	05/14/2018	M E
2	-	-	-
3	-	-	-
4	-	-	-
5	-	-	-
6	-	-	-
7	-	-	-
8	-	-	-
9	-	-	-
10	-	-	-

Project

NorthClad AL Stacking System

11831 Beverly Park Rd, Bldg C
Everett, WA 98204

Category
DET

Scale
3" = 1'-0"

Job Number
NC0000

Sheet
K2

APPROVED

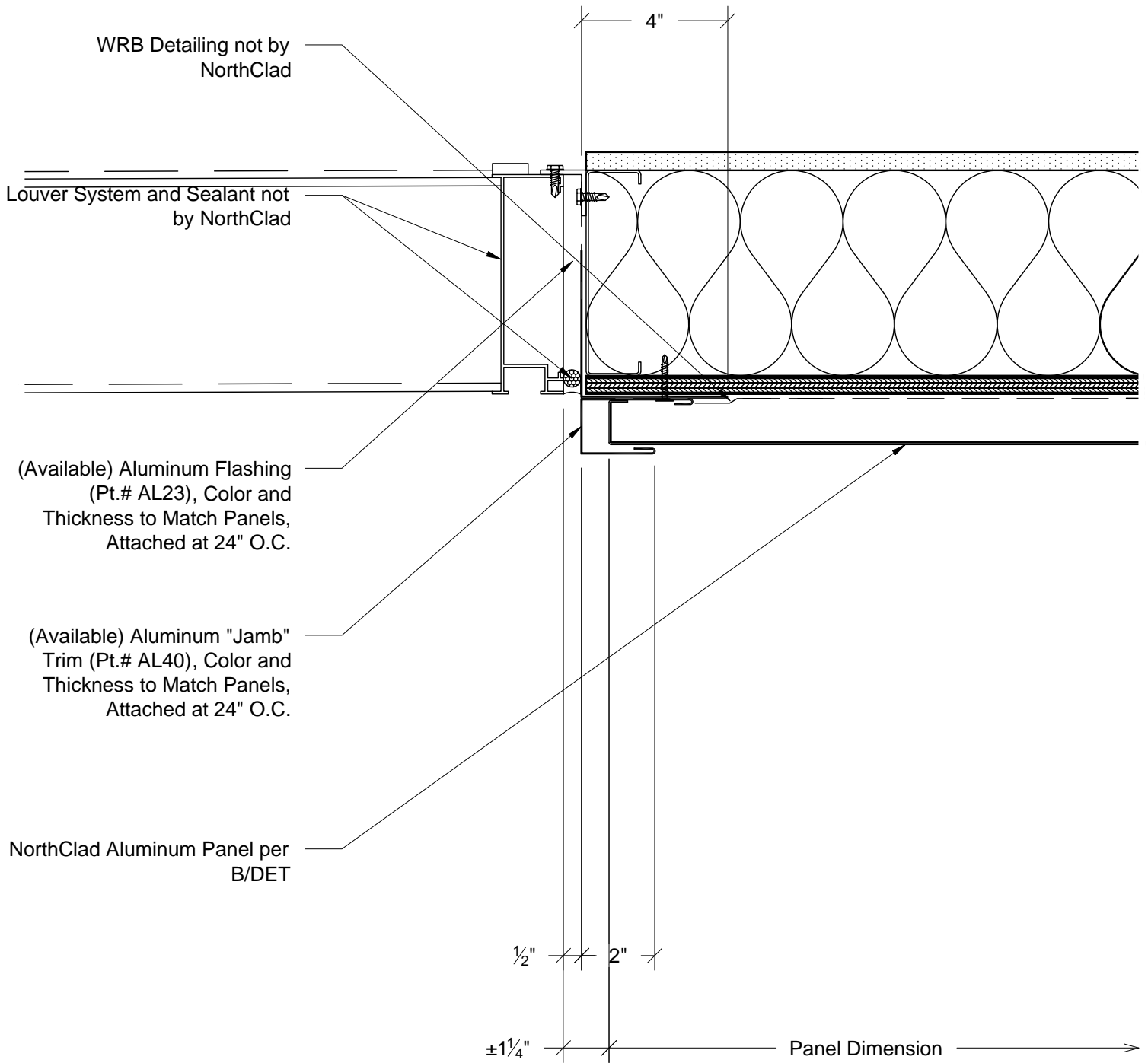

K2

Plan - Left Edge of Panel at Louver Jamb
System: AL Stacking with Inboard Insulation



11831 BEVERLY PARK RD. BUILDING C, EVERETT, WA 98204
* PHONE: 425.740.3702 * FAX: 425.485.3503 *
www.northclad.com

This document is property of NorthClad and should not be used, duplicated or modified without the express written consent. Copyright © 2010 NorthClad All Rights Reserved

NO.	DESCRIPTION	DATE	INIT.
1	Design	05/14/2018	M E
2	-	-	-
3	-	-	-
4	-	-	-
5	-	-	-
6	-	-	-
7	-	-	-
8	-	-	-
9	-	-	-
10	-	-	-

Project

NorthClad AL Stacking System

11831 Beverly Park Rd, Bldg C
Everett, WA 98204

Category	ALT
Scale	3" = 1'-0"
Job Number	NC0000
Sheet	K2
APPROVED	

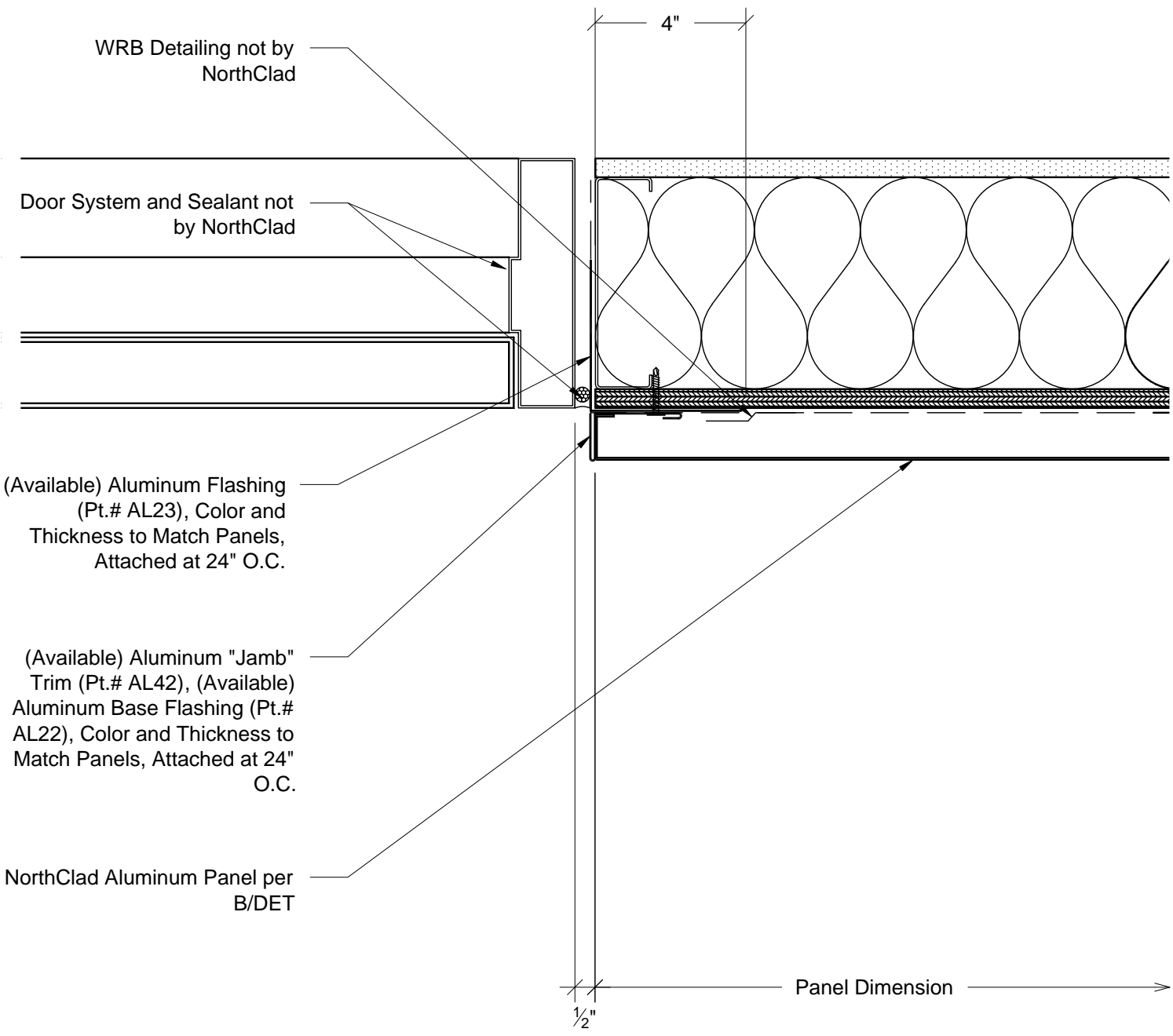

K3

Plan - Left Edge of Panel at Door Jamb
System: AL Stacking with Inboard Insulation



11831 BEVERLY PARK RD. BUILDING C, EVERETT, WA 98204
* PHONE: 425.740.3702 * FAX: 425.485.3503 *
www.northclad.com

This document is property of NorthClad and should not be used, duplicated or modified without the express written consent. Copyright © 2010 NorthClad All Rights Reserved

NO.	DESCRIPTION	DATE	INIT.
1	Design	05/14/2018	M E
2	-	-	-
3	-	-	-
4	-	-	-
5	-	-	-
6	-	-	-
7	-	-	-
8	-	-	-
9	-	-	-
10	-	-	-

Project

NorthClad AL Stacking System

11831 Beverly Park Rd, Bldg C
Everett, WA 98204

Category
DET

Scale
3" = 1'-0"

Job Number
NC0000

Sheet
K3

APPROVED

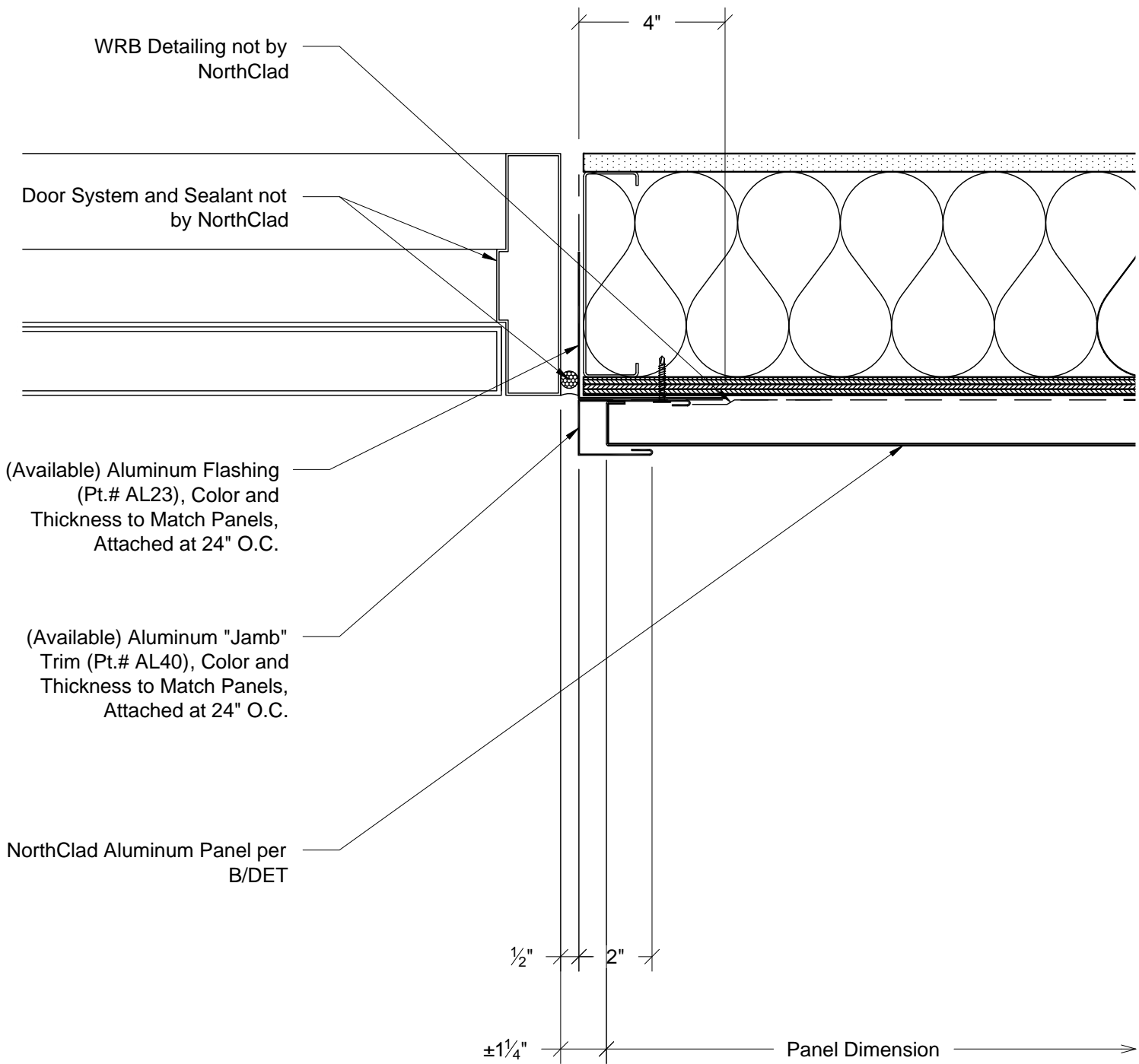

K3

Plan - Left Edge of Panel at Door Jamb
System: AL Stacking with Inboard Insulation



11831 BEVERLY PARK RD. BUILDING C, EVERETT, WA 98204
* PHONE: 425.740.3702 * FAX: 425.485.3503 *
www.northclad.com

This document is property of NorthClad and should not be used, duplicated or modified without the express written consent. Copyright © 2010 NorthClad All Rights Reserved

NO.	DESCRIPTION	DATE	INIT.
1	Design	05/14/2018	M E
2	-	-	-
3	-	-	-
4	-	-	-
5	-	-	-
6	-	-	-
7	-	-	-
8	-	-	-
9	-	-	-
10	-	-	-

Project

NorthClad AL Stacking System

11831 Beverly Park Rd, Bldg C
Everett, WA 98204

Category
ALT

Scale
3" = 1'-0"

Job Number
NC0000

Sheet
K3

APPROVED

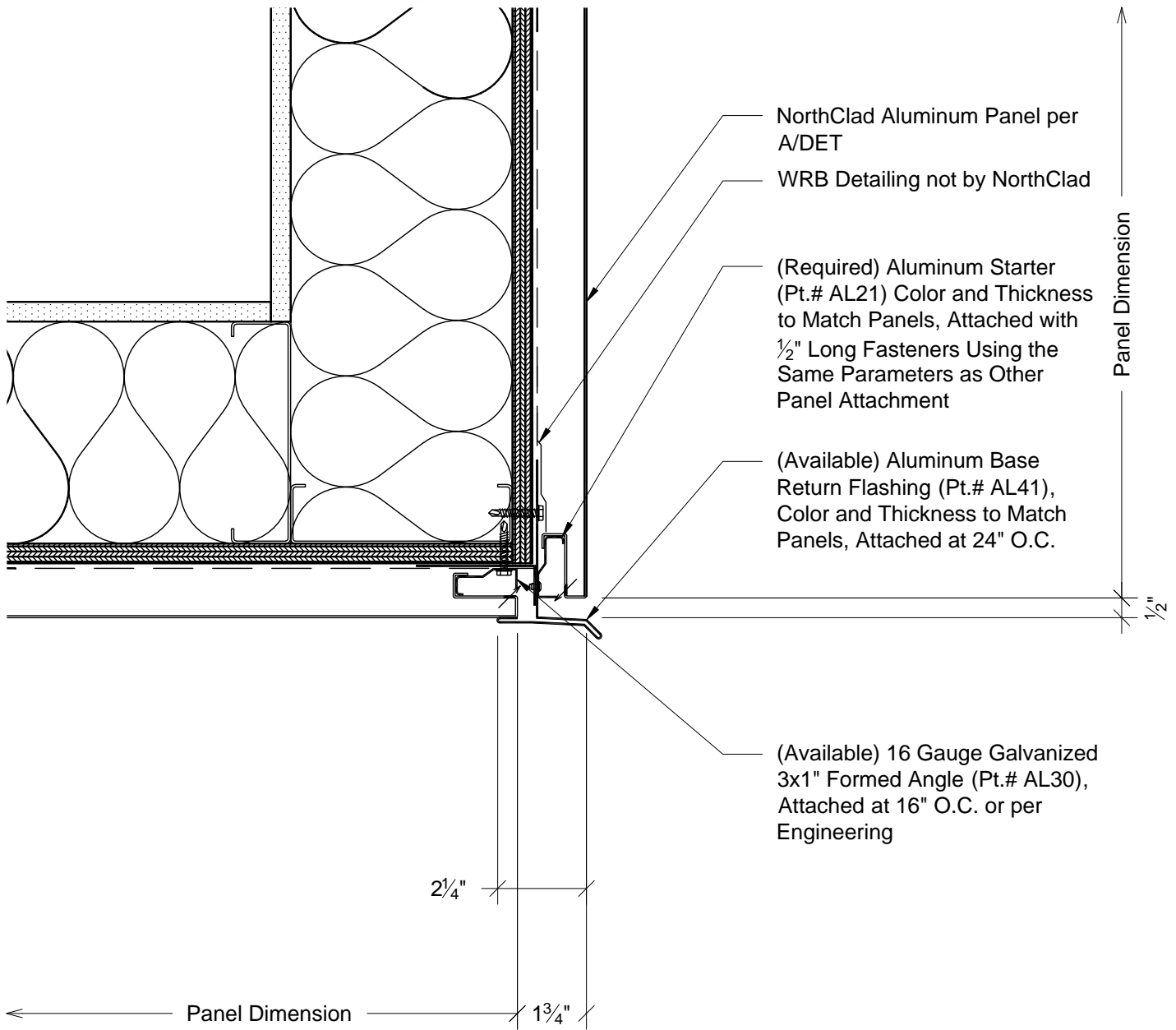

- NorthClad Aluminum Panel per A/DET
- WRB Detailing not by NorthClad
- (Required) Aluminum Starter (Pt.# AL21) Color and Thickness to Match Panels, Attached with 1/2" Long Fasteners Using the Same Parameters as Other Panel Attachment
- (Available) Aluminum Base Return Flashing (Pt.# AL41), Color and Thickness to Match Panels, Attached at 24" O.C.
- (Available) 16 Gauge Galvanized 3x1" Formed Angle (Pt.# AL30), Attached at 16" O.C. or per Engineering

M1

Section - Panels at Fascia to Soffit Transition
 System: AL Stacking with Inboard Insulation



11831 BEVERLY PARK RD. BUILDING C, EVERETT, WA 98204
 * PHONE: 425.740.3702 * FAX: 425.485.3503 *
 www.northclad.com

This document is property of NorthClad and should not be used, duplicated or modified without the express written consent. Copyright © 2010 NorthClad All Rights Reserved

NO.	DESCRIPTION	DATE	INIT.
1	Design	05/14/2018	M E
2	-	-	-
3	-	-	-
4	-	-	-
5	-	-	-
6	-	-	-
7	-	-	-
8	-	-	-
9	-	-	-
10	-	-	-

Project

NorthClad AL Stacking System

11831 Beverly Park Rd, Bldg C
 Everett, WA 98204

Category	DET
Scale	3" = 1'-0"
Job Number	NC0000
Sheet	M1
APPROVED	

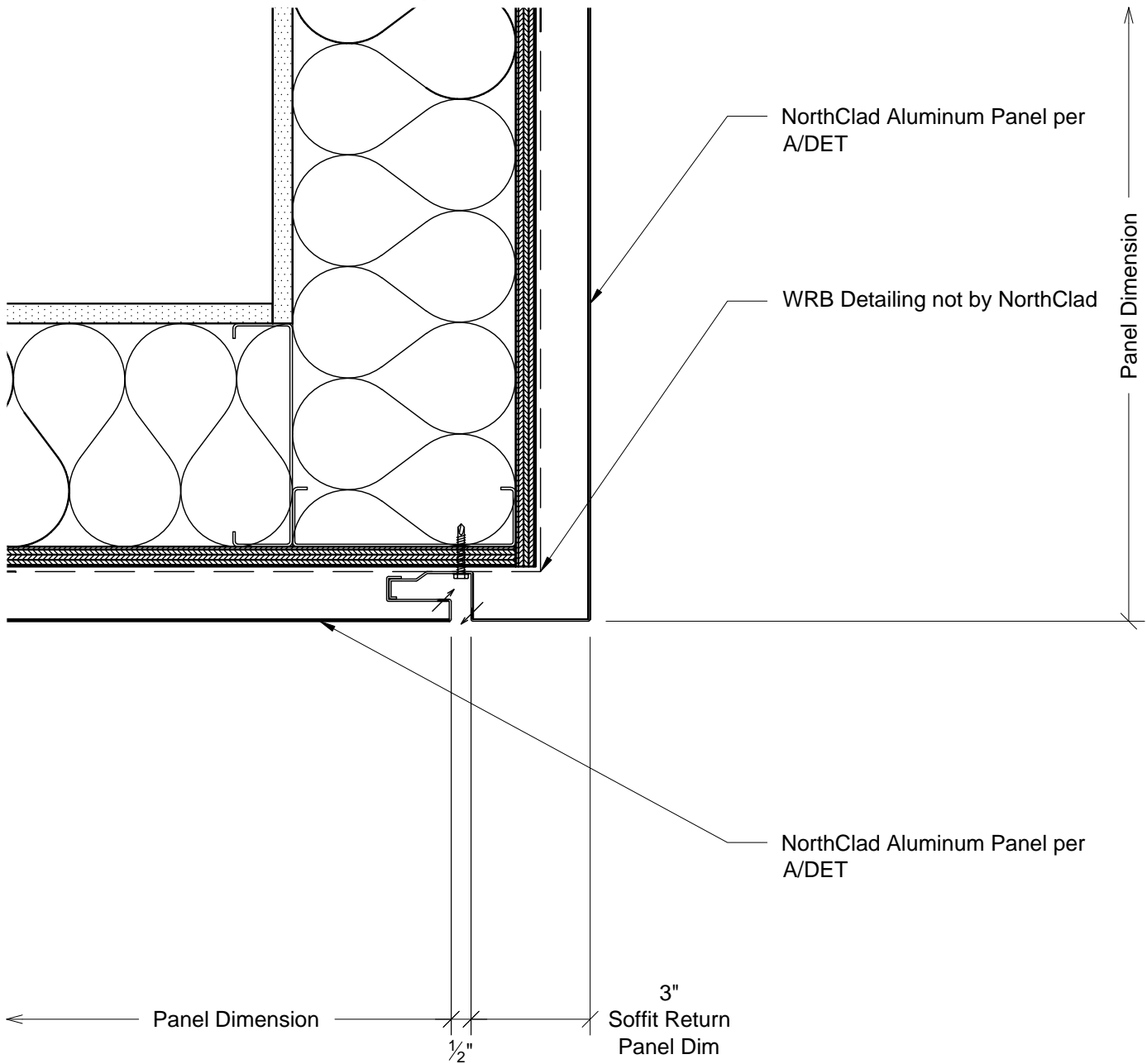

M1 Section - Panels at Fascia to Soffit Transition
System: AL Stacking with Inboard Insulation



11831 BEVERLY PARK RD. BUILDING C, EVERETT, WA 98204
* PHONE: 425.740.3702 * FAX: 425.485.3503 *
www.northclad.com

This document is property of NorthClad and should not be used, duplicated or modified without the express written consent. Copyright © 2010 NorthClad All Rights Reserved

NO.	DESCRIPTION	DATE	INIT.
1	Design	05/14/2018	M E
2	-	-	-
3	-	-	-
4	-	-	-
5	-	-	-
6	-	-	-
7	-	-	-
8	-	-	-
9	-	-	-
10	-	-	-

Project
NorthClad AL Stacking System

11831 Beverly Park Rd, Bldg C
Everett, WA 98204

Category	ALT
Scale	3" = 1'-0"
Job Number	NC0000
Sheet	M1
APPROVED	

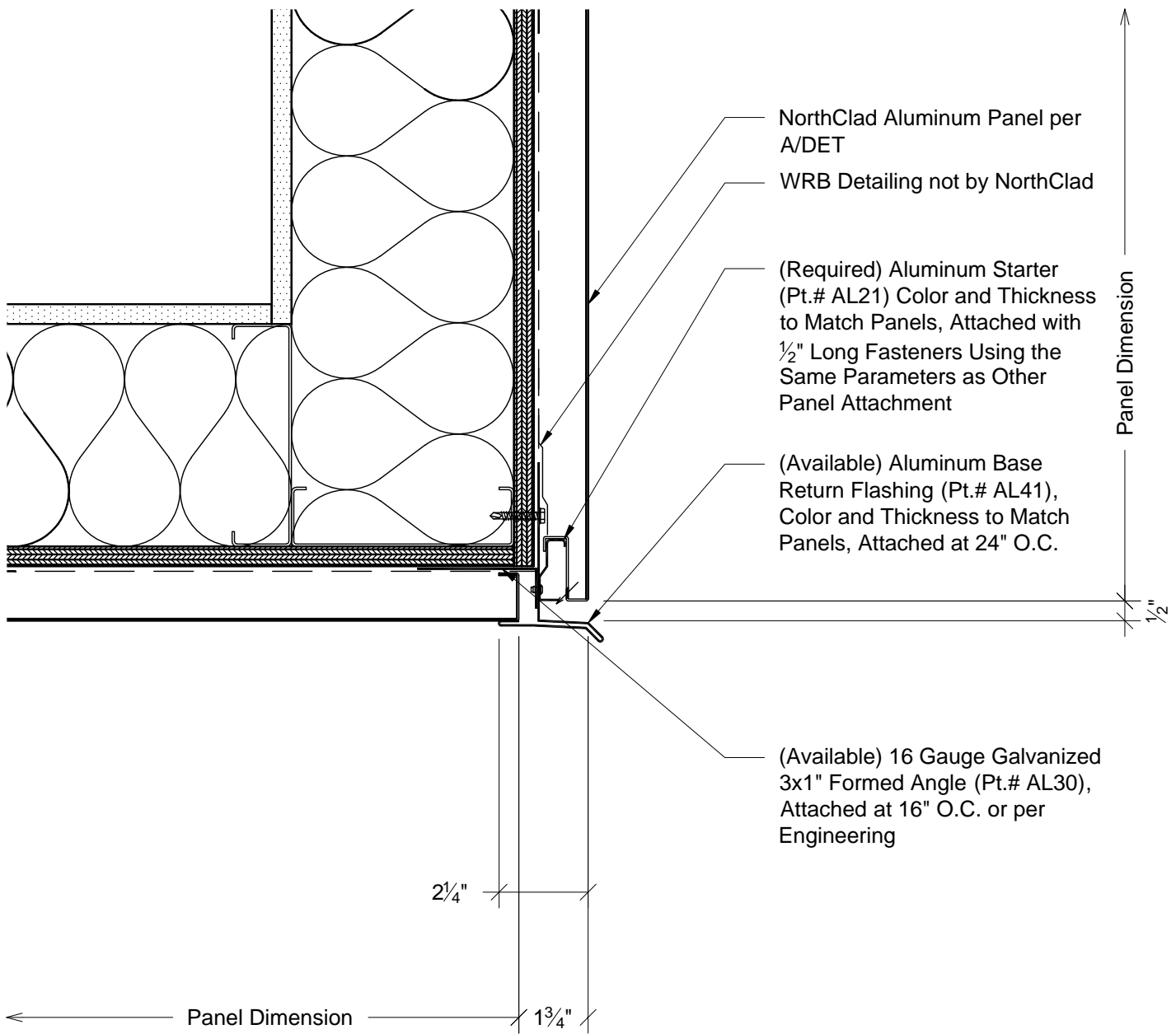

- NorthClad Aluminum Panel per A/DET
- WRB Detailing not by NorthClad
- (Required) Aluminum Starter (Pt.# AL21) Color and Thickness to Match Panels, Attached with 1/2" Long Fasteners Using the Same Parameters as Other Panel Attachment
- (Available) Aluminum Base Return Flashing (Pt.# AL41), Color and Thickness to Match Panels, Attached at 24" O.C.
- (Available) 16 Gauge Galvanized 3x1" Formed Angle (Pt.# AL30), Attached at 16" O.C. or per Engineering

Panel Dimension

1/2"

2 1/4"

1 3/4"

Panel Dimension

M2 Section - Panels at Soffit to Fascia Transition
System: AL Stacking with Inboard Insulation



11831 BEVERLY PARK RD. BUILDING C, EVERETT, WA 98204
* PHONE: 425.740.3702 * FAX: 425.485.3503 *
www.northclad.com

This document is property of NorthClad and should not be used, duplicated or modified without the express written consent. Copyright © 2010 NorthClad All Rights Reserved

NO.	DESCRIPTION	DATE	INIT.
1	Design	05/14/2018	M E
2	-	-	-
3	-	-	-
4	-	-	-
5	-	-	-
6	-	-	-
7	-	-	-
8	-	-	-
9	-	-	-
10	-	-	-

Project

NorthClad AL Stacking System

11831 Beverly Park Rd, Bldg C
Everett, WA 98204

Category	DET
Scale	3" = 1'-0"
Job Number	NC0000
Sheet	M2
APPROVED	

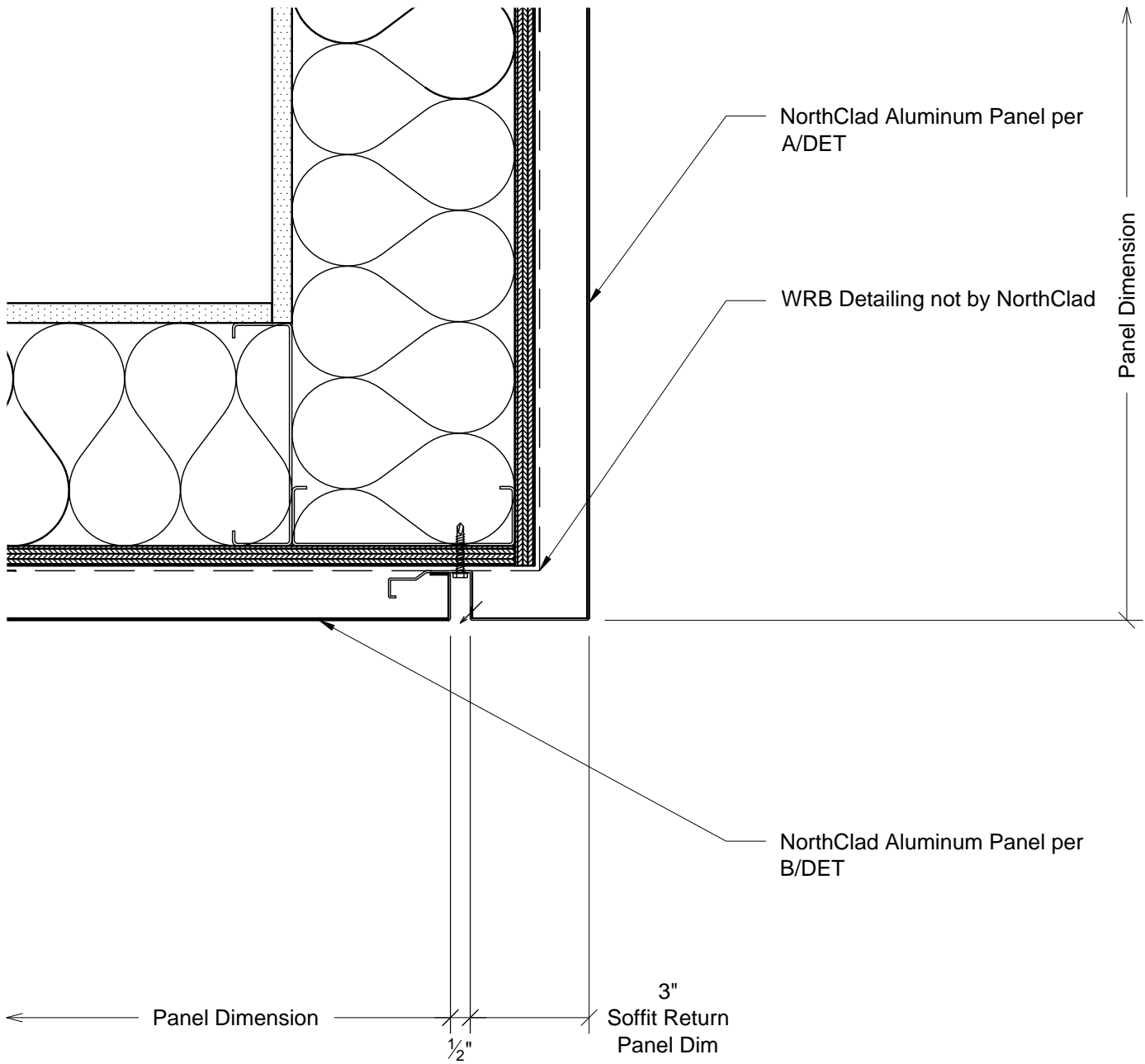

M2 Section - Panels at Soffit to Fascia Transition
System: AL Stacking with Inboard Insulation



11831 BEVERLY PARK RD. BUILDING C, EVERETT, WA 98204
* PHONE: 425.740.3702 * FAX: 425.485.3503 *
www.northclad.com

This document is property of NorthClad and should not be used, duplicated or modified without the express written consent. Copyright © 2010 NorthClad All Rights Reserved

NO.	DESCRIPTION	DATE	INIT.
1	Design	05/14/2018	M E
2	-	-	-
3	-	-	-
4	-	-	-
5	-	-	-
6	-	-	-
7	-	-	-
8	-	-	-
9	-	-	-
10	-	-	-

Project
NorthClad AL Stacking System

11831 Beverly Park Rd, Bldg C
Everett, WA 98204

Category	ALT
Scale	3" = 1'-0"
Job Number	NC0000
Sheet	M2
APPROVED	

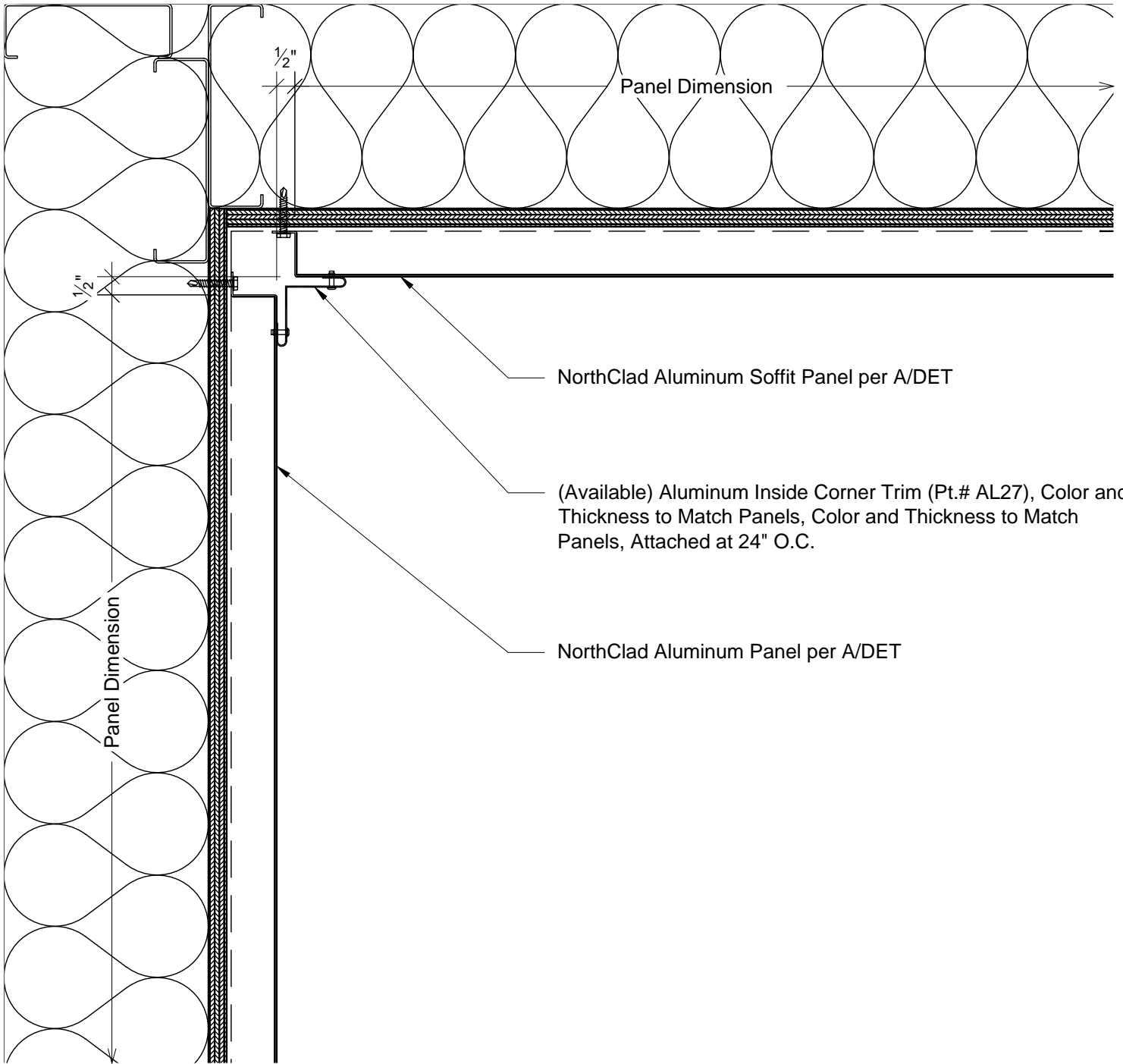

N1

Section - Panels at Wall to Soffit Transition
 System: AL Stacking with Inboard Insulation



11831 BEVERLY PARK RD. BUILDING C, EVERETT, WA 98204
 * PHONE: 425.740.3702 * FAX: 425.485.3503 *
 www.northclad.com

This document is property of NorthClad and should not be used, duplicated or modified without the express written consent. Copyright © 2010 NorthClad All Rights Reserved

NO.	DESCRIPTION	DATE	INIT.
1	Design	05/14/2018	M E
2	-	-	-
3	-	-	-
4	-	-	-
5	-	-	-
6	-	-	-
7	-	-	-
8	-	-	-
9	-	-	-
10	-	-	-

Project

NorthClad AL Stacking System

11831 Beverly Park Rd, Bldg C
 Everett, WA 98204

Category	DET
Scale	3" = 1'-0"
Job Number	NC0000
Sheet	N1
APPROVED	