

Foil Faced WRB, Around Framed Opening not by NorthClad

Louver, Flashing, Trim, Primary and Secondary Sealant not by NorthClad

EFEB - See 01/Comp for Detailed Information

5/16" Phenolic Plank Panel

CRHB - See A1/DET for Further Information

Code Compliant Insulation and/or Standoff, as Applicable, not by NorthClad

WRB, if Required, not by NorthClad

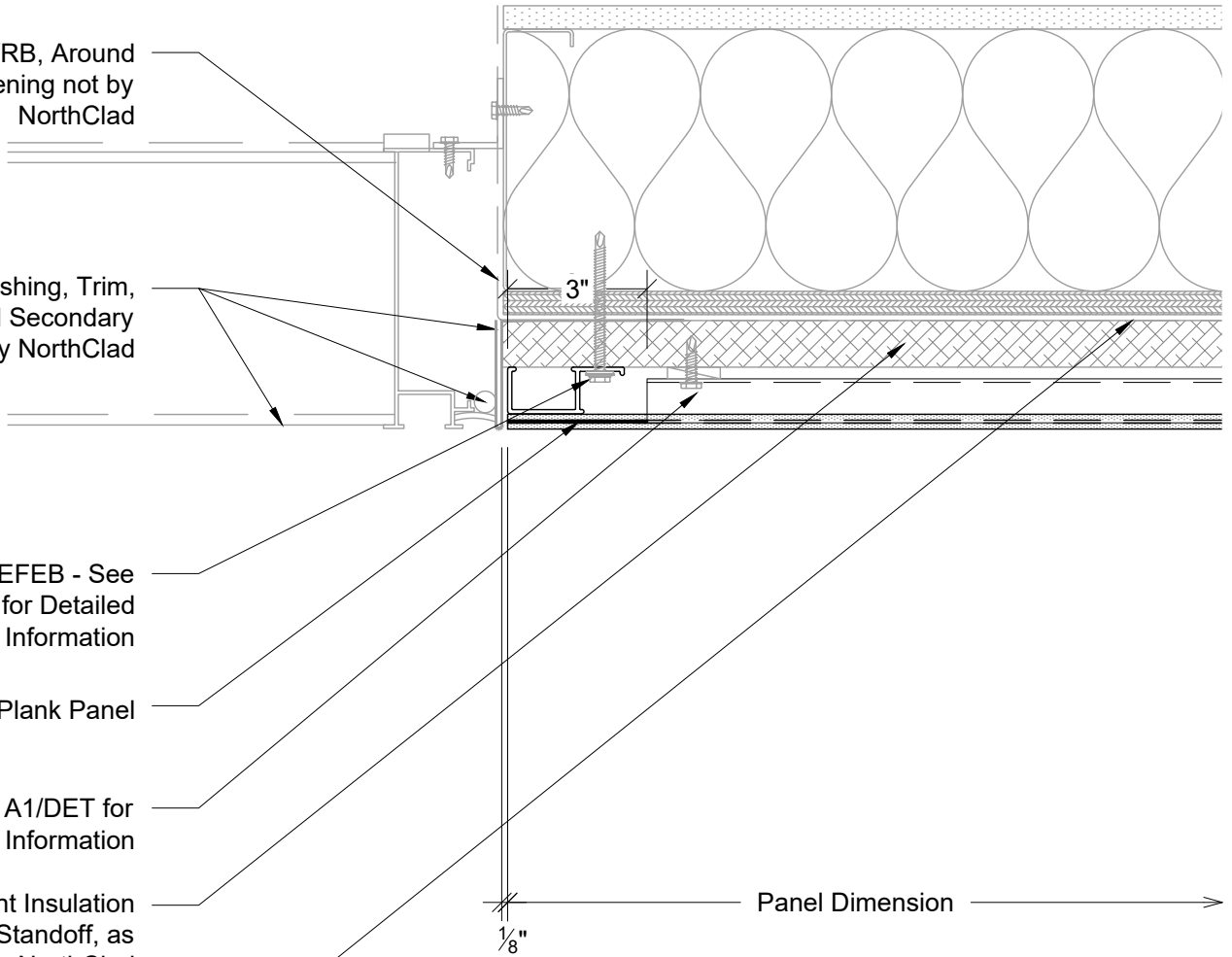

Panel Dimension

Plan - Louver at Right Jamb



11831 BEVERLY PARK RD. BUILDING C, EVERETT, WA 98204
 * PHONE: 425.740.3702 * FAX: 425.485.3503 *
 www.northclad.com

This document is property of NorthClad and should not be used, duplicated or modified without the express written consent. Copyright © 2010 NorthClad All Rights Reserved

NO.	DESCRIPTION	DATE	INIT.
1	Design	02/28/2022	M.E.
2			
3			
4			
5			
6			
7			
8			
9			
10			

Project

CR System for Phenolic Plank

NC Stds w/Outboard Insulation

11831 Beverly Park Rd, Bldg C
 Everett, WA 98204

Scale 3" = 1'-0"

Job Number

Sheet

DET M2

APPROVED