

Fasten Furring Into Aligned Stud Or Horizontal Blocking. Spacing Per Engineering, 16" O.C. MAX

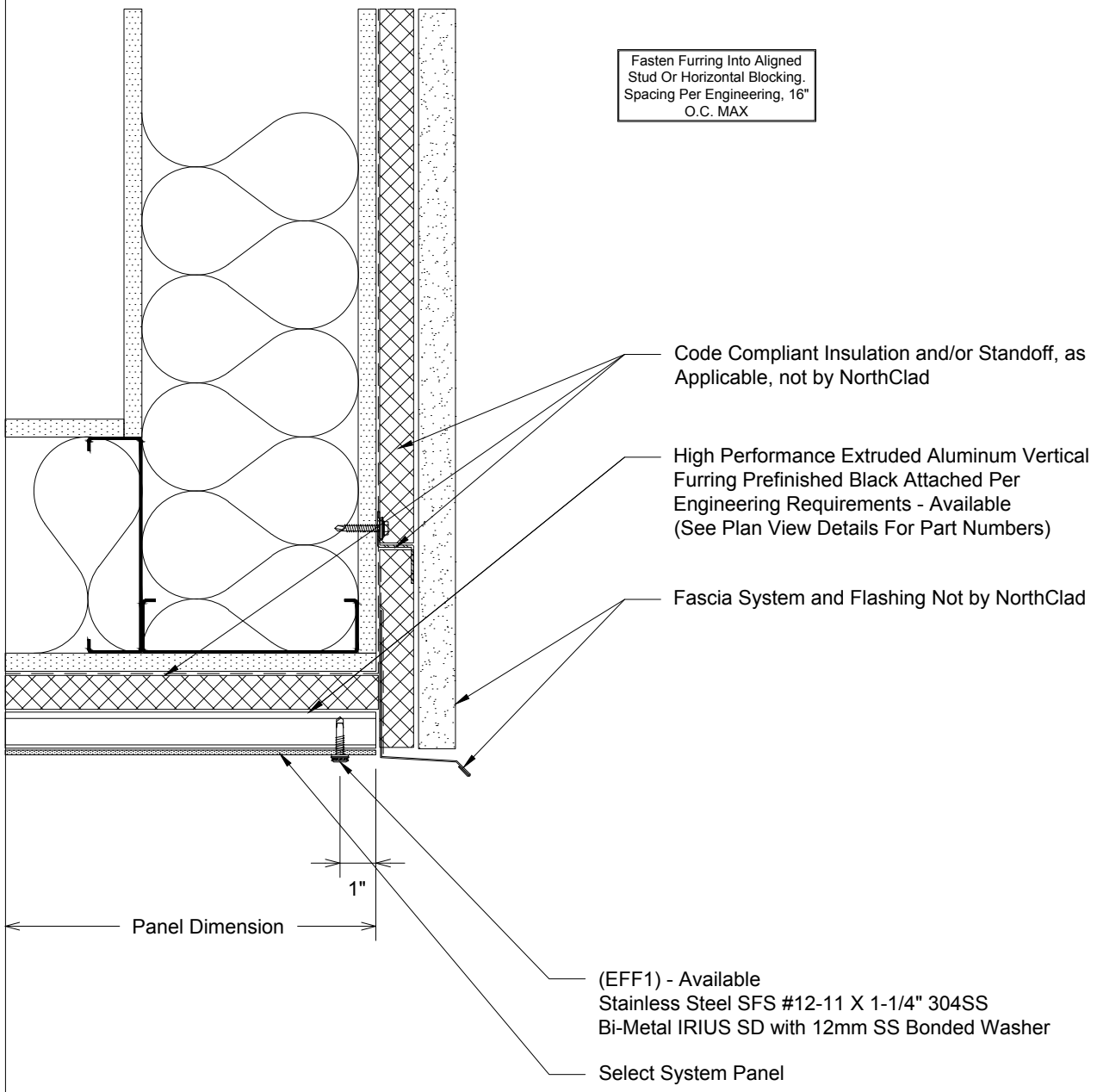

Code Compliant Insulation and/or Standoff, as Applicable, not by NorthClad

High Performance Extruded Aluminum Vertical Furring Prefinished Black Attached Per Engineering Requirements - Available (See Plan View Details For Part Numbers)

Fascia System and Flashing Not by NorthClad

(EFF1) - Available
Stainless Steel SFS #12-11 X 1-1/4" 304SS
Bi-Metal IRIUS SD with 12mm SS Bonded Washer

Select System Panel

F

Section - NorthClad EF - Soffit to Fascia by Others
System: NorthClad EF System