

Fasten Furring Into Aligned Stud Or Horizontal Blocking. Spacing Per Engineering, 16" O.C. MAX

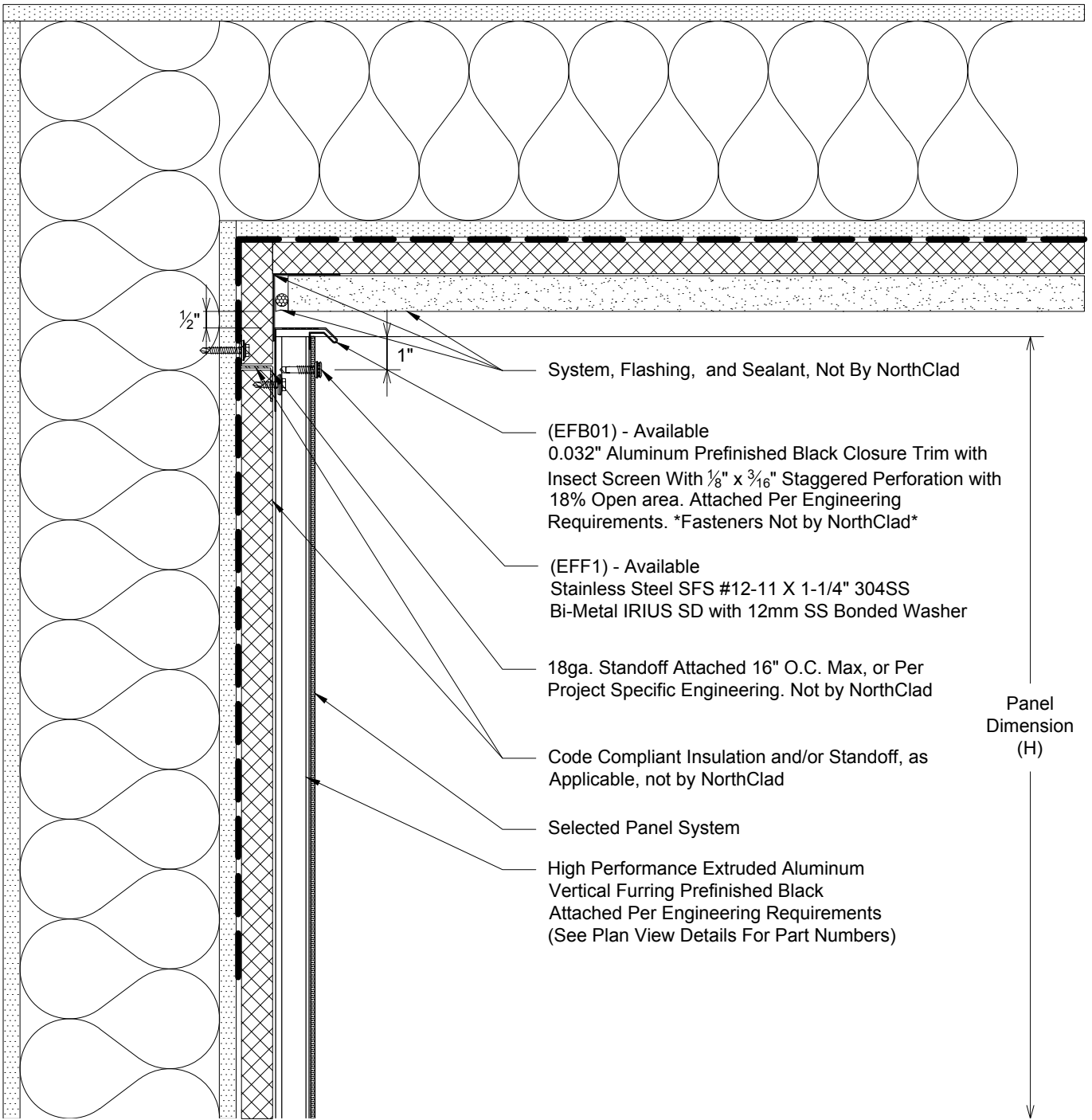

System, Flashing, and Sealant, Not By NorthClad

(EFB01) - Available
0.032" Aluminum Prefinished Black Closure Trim with Insect Screen With $\frac{1}{8}$ " x $\frac{3}{16}$ " Staggered Perforation with 18% Open area. Attached Per Engineering Requirements. *Fasteners Not by NorthClad*

(EFF1) - Available
Stainless Steel SFS #12-11 X 1-1/4" 304SS Bi-Metal IRIUS SD with 12mm SS Bonded Washer

18ga. Standoff Attached 16" O.C. Max, or Per Project Specific Engineering. Not by NorthClad

Code Compliant Insulation and/or Standoff, as Applicable, not by NorthClad

Selected Panel System

High Performance Extruded Aluminum Vertical Furring Prefinished Black Attached Per Engineering Requirements (See Plan View Details For Part Numbers)

Panel Dimension (H)

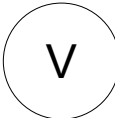

Section - NorthClad EF - Wall to Soffit by Others
System: NorthClad EF System